

Monteringsanvisning

MADISON

100453/2019.06

2/3-SITS MED SCHÄSLONG

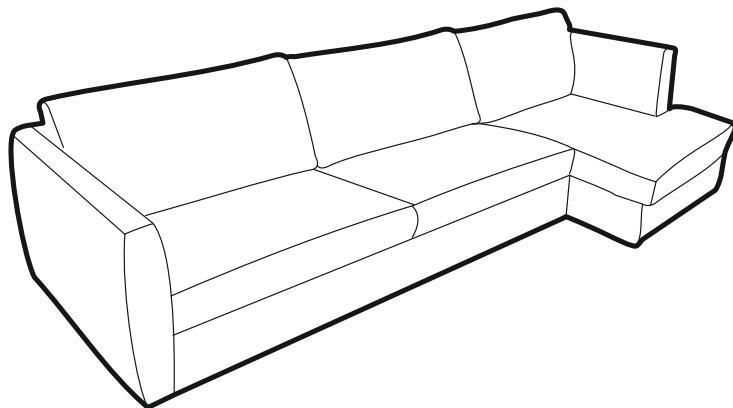

MADISON A

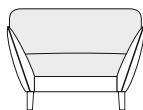

MADISON B

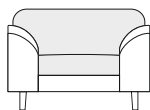

MADISON C

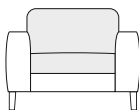

MADISON D

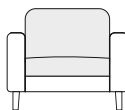

MADISON E

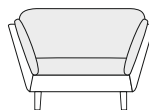

MADISON F

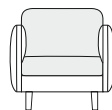

Du behöver



ca 0,5 timmar

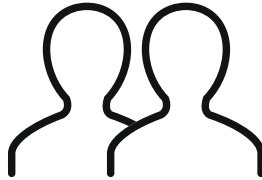

2 personer

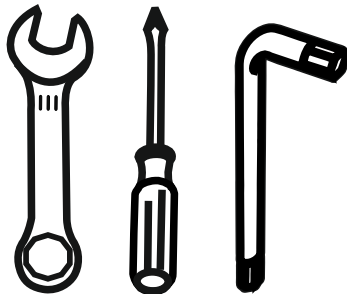

Har du frågor om monteringen av dina möbler?

Hör av dig till din Mio-butik eller ring till vår kundservice 020 66 44 00

Ingående delar

Ben alternativ

A NR 91

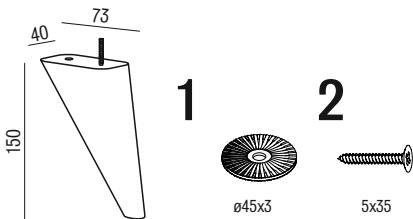

NR 91

NR	ANTAL	mm
A	6	73x150
1	6	$\varnothing 45 \times 3$
2	6	5x35

B NR 141 A

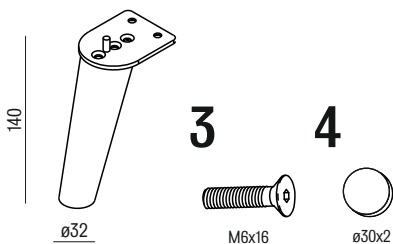

NR 141 A

NR	ANTAL	mm
B	6	$\varnothing 32 \times 140$
3	12	M6x16
4	6	$\varnothing 30 \times 2$

C NR 152

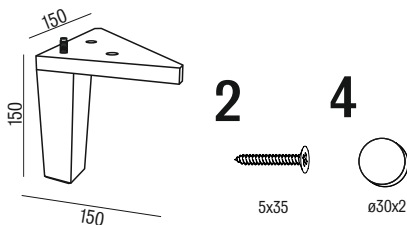

NR 152

NR	ANTAL	mm
C	6	150x150
2	12	5x35
4	6	$\varnothing 30 \times 2$

D NR 145A

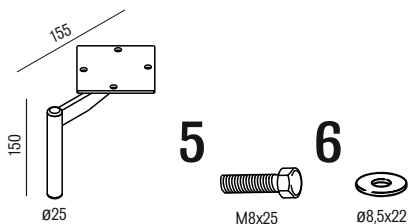

NR 145A

NR	ANTAL	mm
D	6	150x155
5	18	M8x25
6	18	$\varnothing 8,5 \times 22$

1

1



ø45x3

2



5x35



ARMSTÖD I

- Madison A
- Madison B
- Madison C
- Madison D

STOMME II

- Madison E
- Madison F

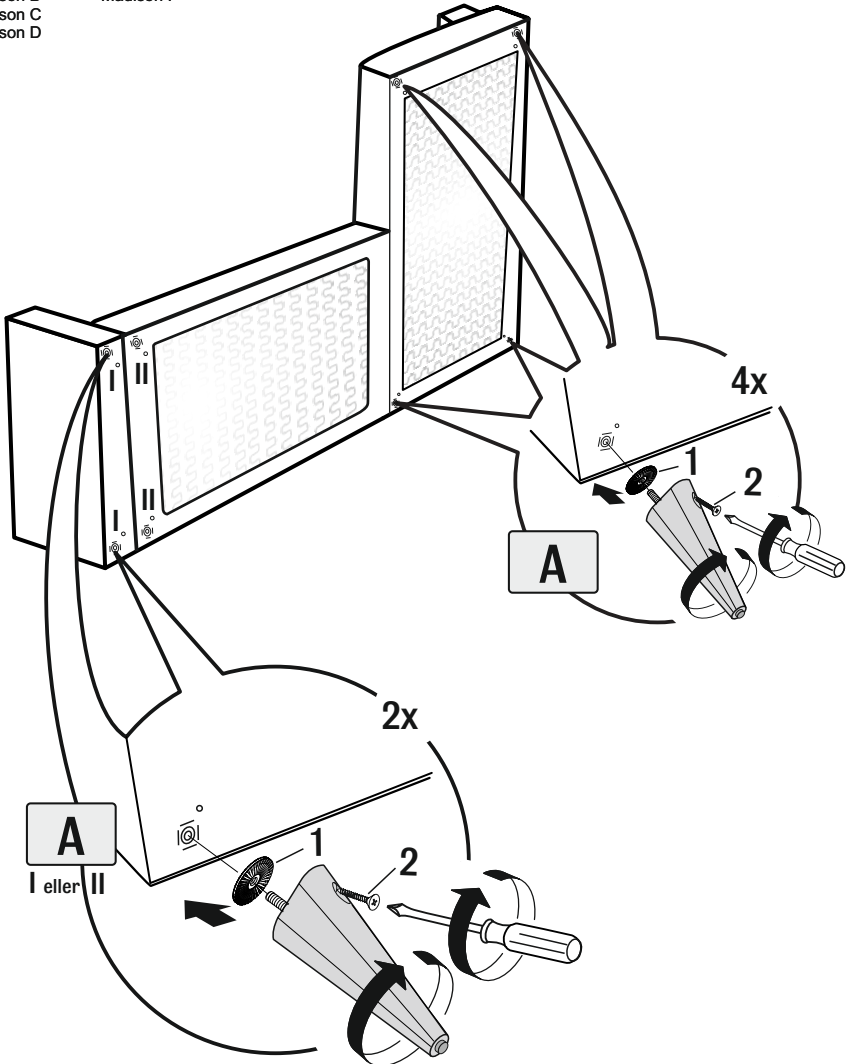

2

3



M6x16

4



ø30x2



L-4

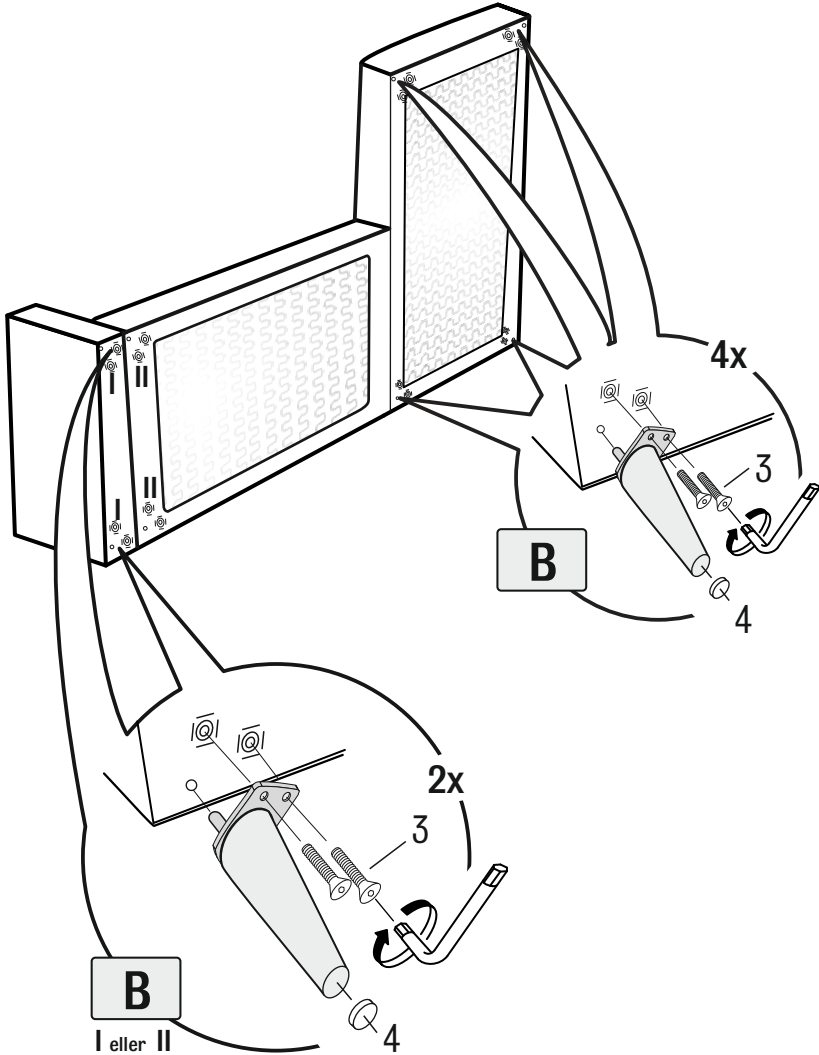

3

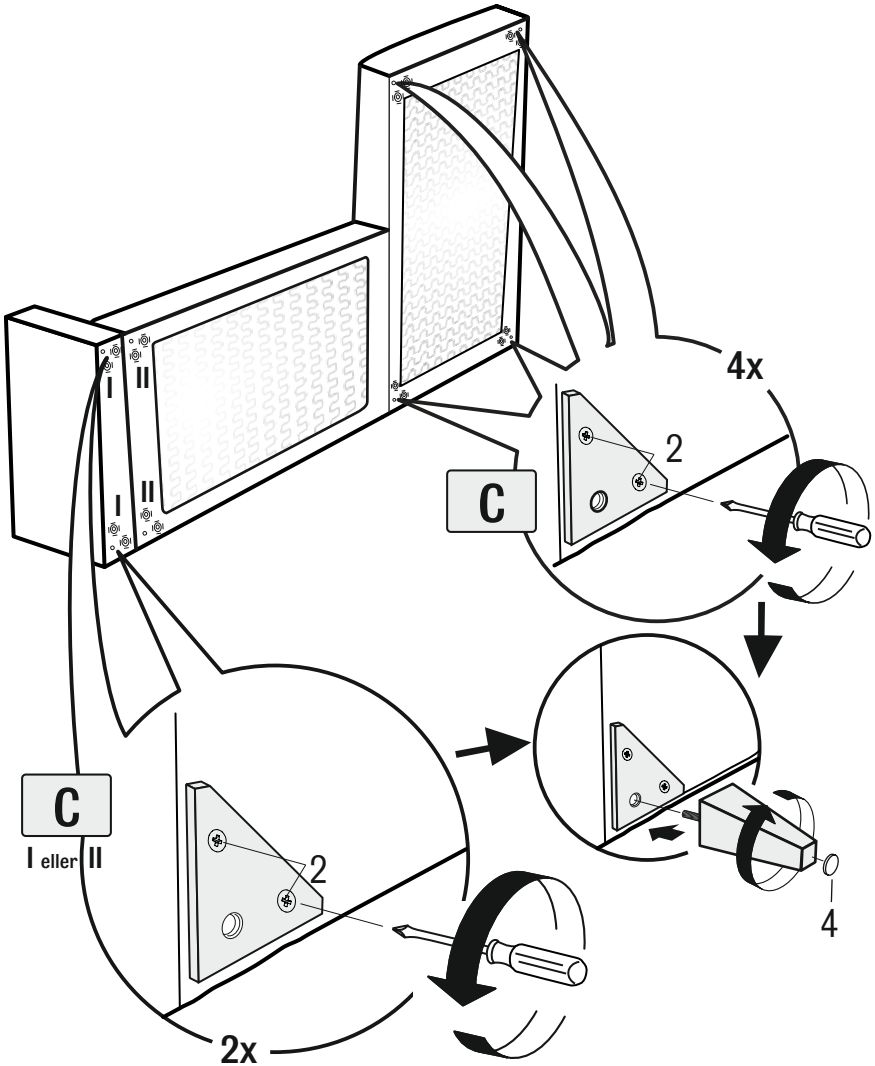

4

5



M8x25

6



ø8,5x22

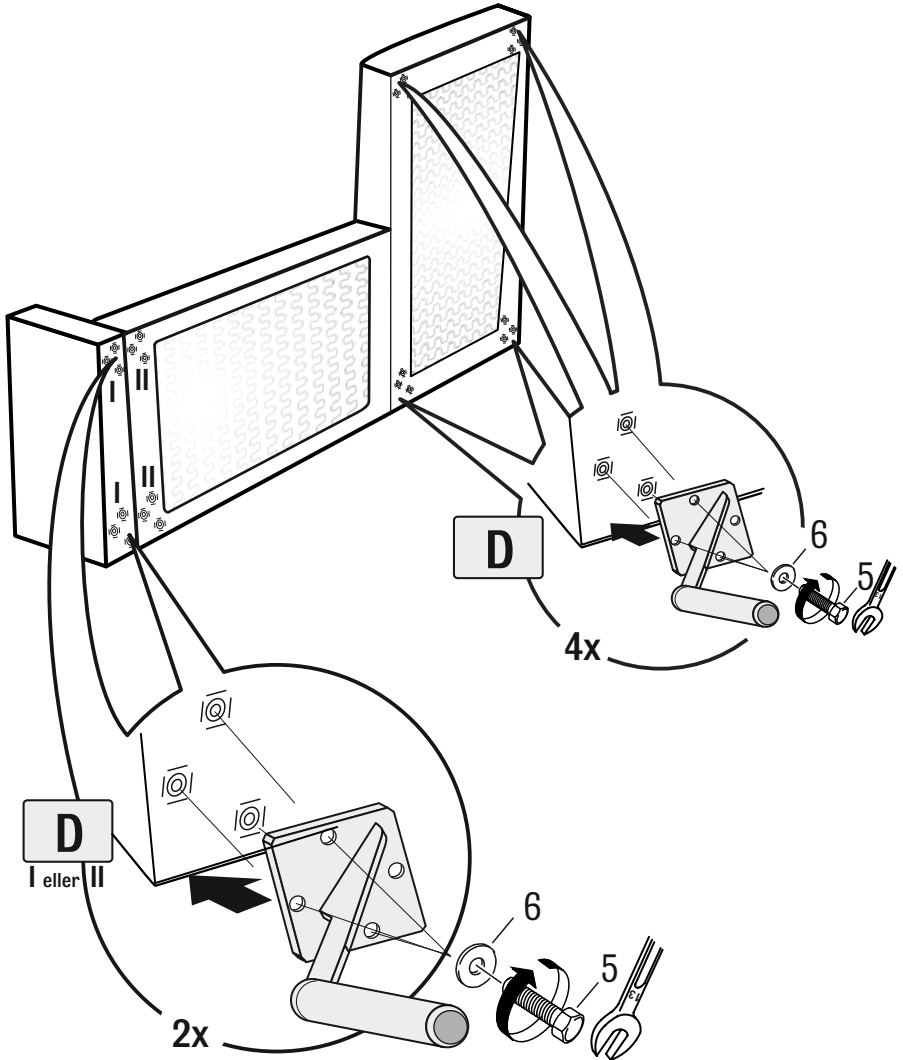

Montering

Följ instruktionerna steg för steg

