

Monteringsanvisning

Cord Soffbord

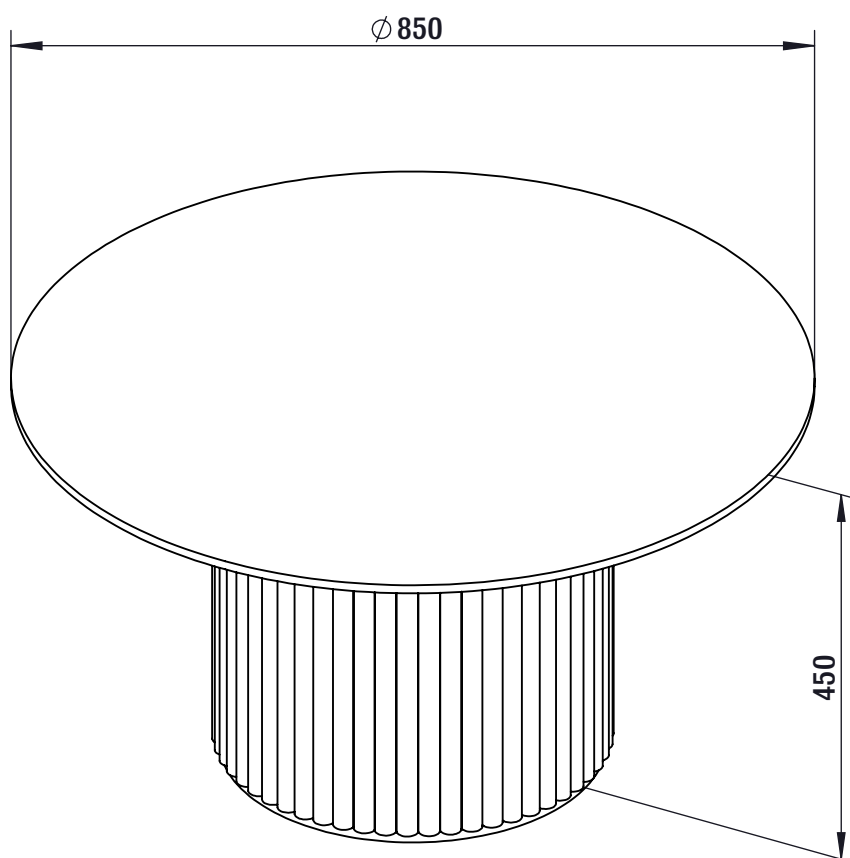

Du behöver

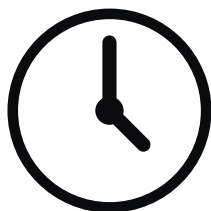

ca 20 minuter

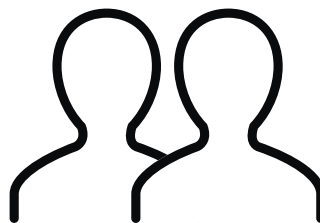

2 personer

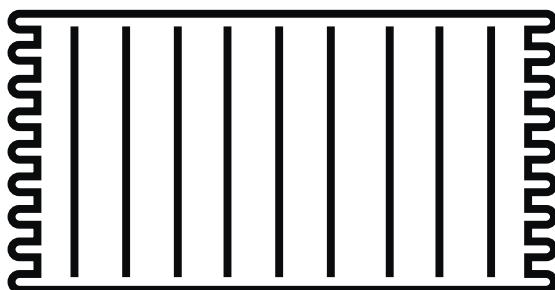
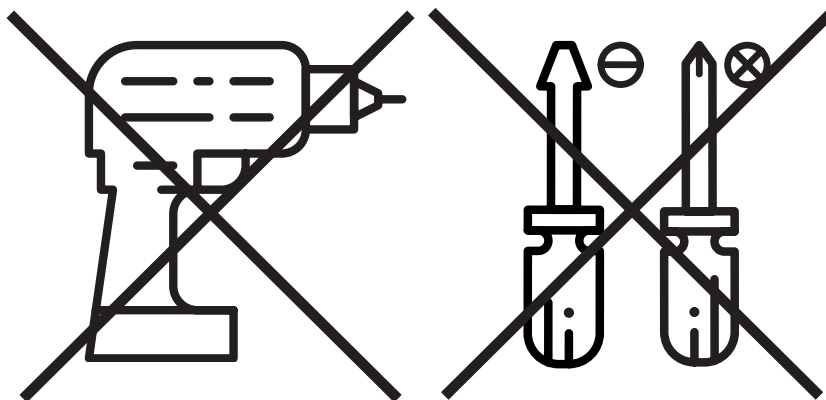

Lägg din produkt på ett mjukt underlag när du monterar



Har du frågor om monteringen av dina möbler?

Hör av dig till din Mio-butik eller ring till vår kundservice 020 66 44 00

Ingående delar

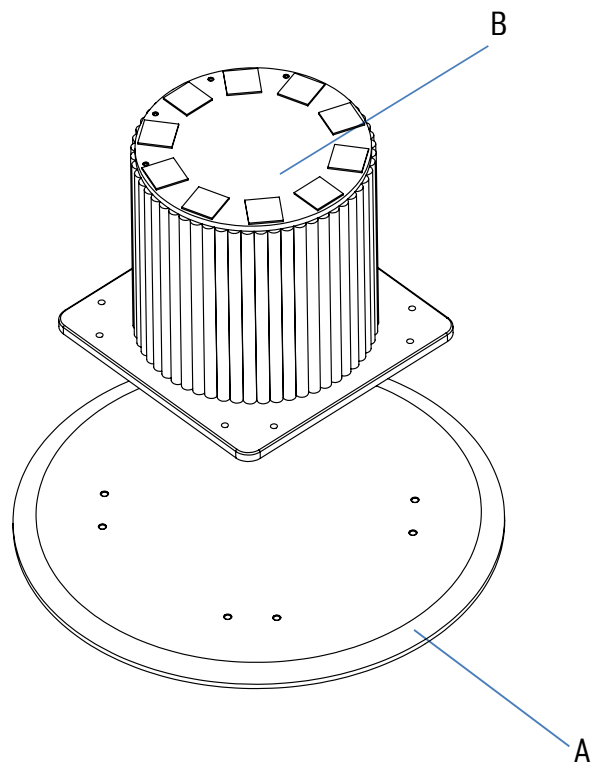

	QTY	mm
A	1	850*850*25
B	1	500*500*425

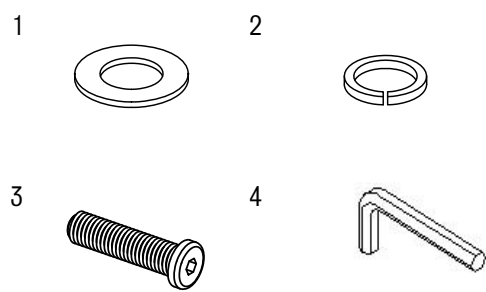

Nr	QTY	mm
1	8	Ø8
2	8	Ø8
3	8	M8*35
4	1	M5

Montering

Följ instruktionerna steg för steg

1

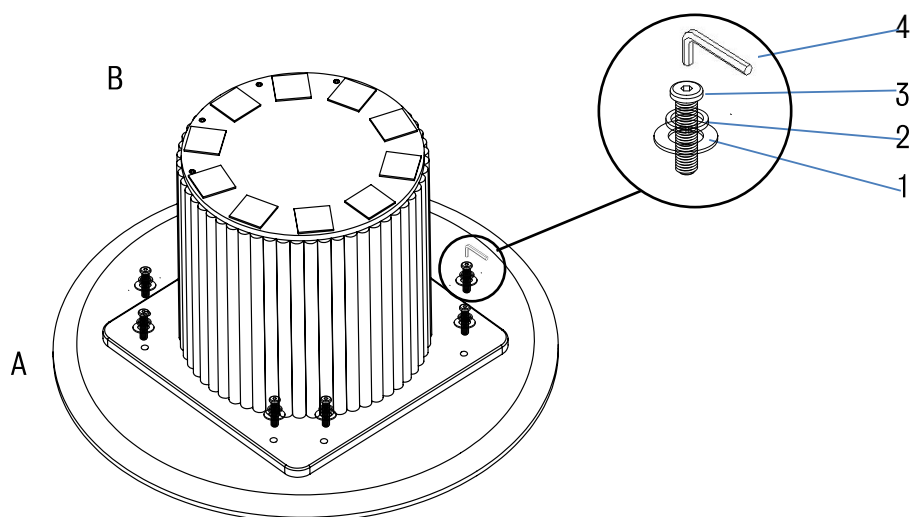

Nr. 1 x 8



Nr. 2 x 8



Nr. 3 x 8

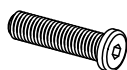

Nr. 4 x 1



2

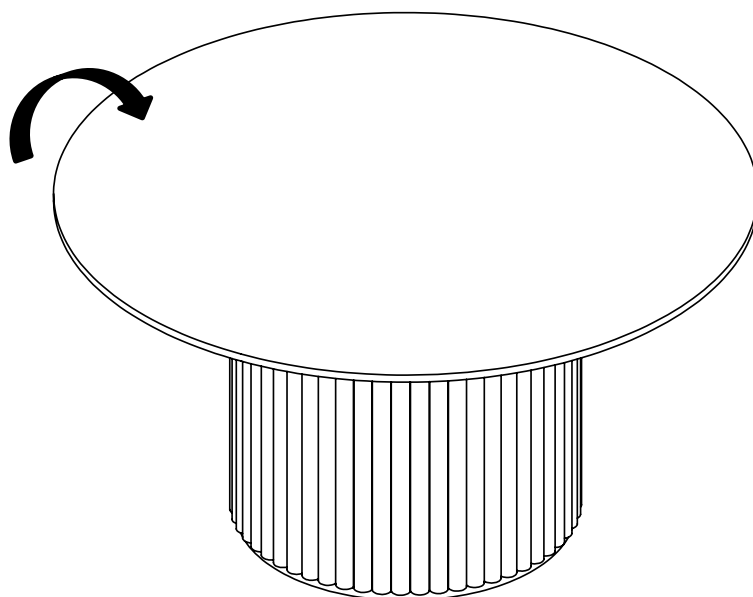



Maxvikt

