

# Monteringsanvisning

# Greta

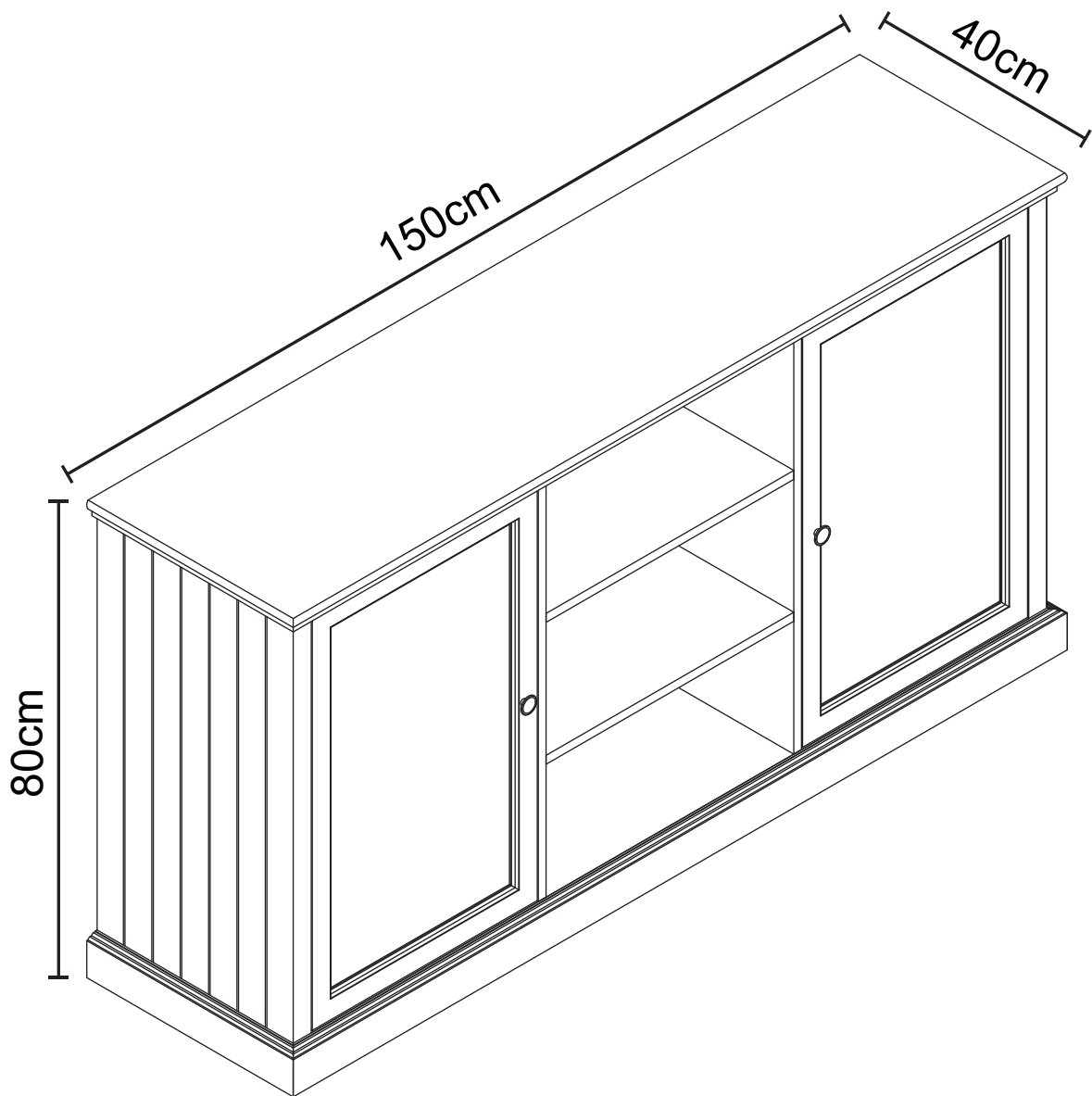

# Du behöver



ca 45 minuter

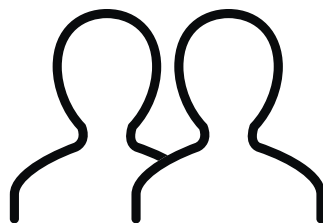

2 personer

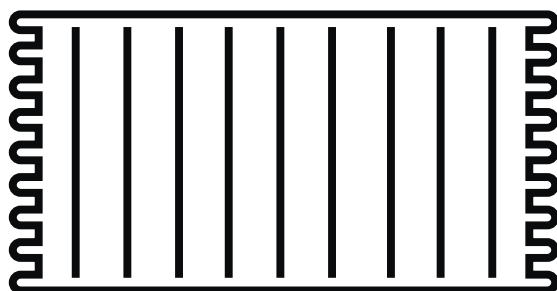
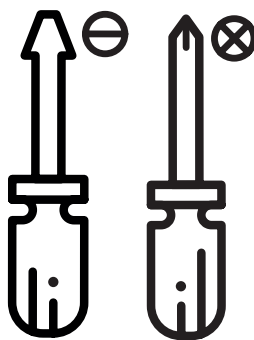
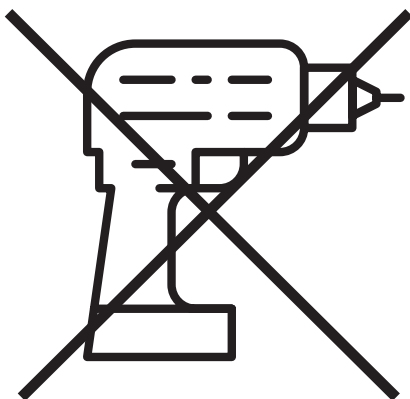

Lägg din produkt på ett mjukt underlag när du monterar



Har du frågor om monteringen av dina möbler?

Hör av dig till din Mio-butik eller ring till vår kundservice 020 66 44 00

# Ingående delar

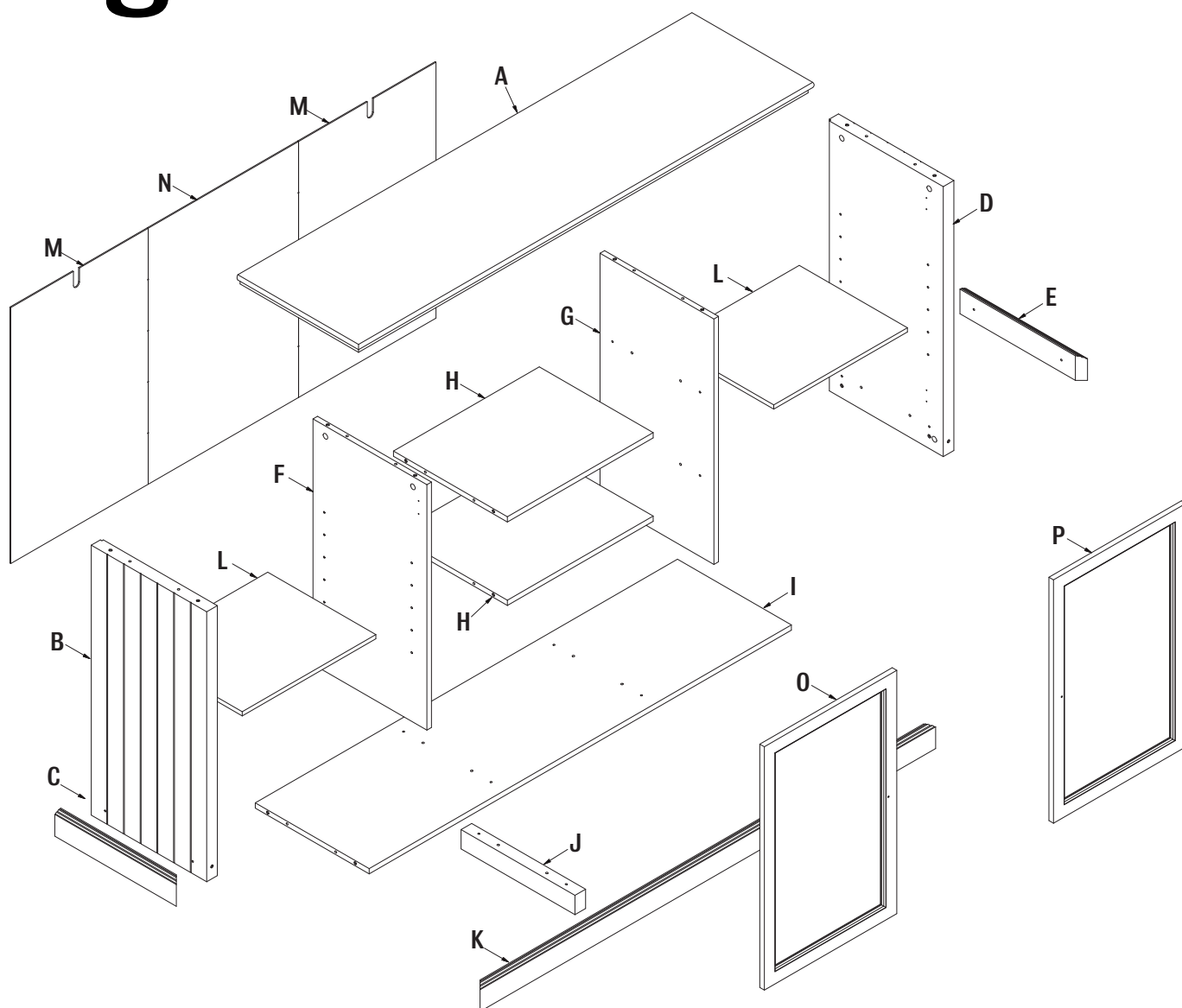

NO.	QTY	mm
<b>A</b>	1	452x375x15
<b>B</b>	1	452x375x15
<b>C</b>	1	452x375x15
<b>D</b>	1	452x375x15
<b>E</b>	1	452x375x15
<b>F</b>	1	452x375x15
<b>G</b>	1	452x375x15
<b>H</b>	2	452x375x15

NO.	QTY	mm
<b>I</b>	1	452x375x15
<b>J</b>	1	452x375x15
<b>K</b>	1	452x375x15
<b>L</b>	2	452x375x15
<b>M</b>	2	452x375x15
<b>N</b>	1	452x375x15
<b>O</b>	1	452x375x15
<b>P</b>	1	452x375x15

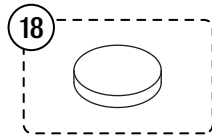
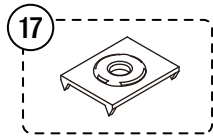
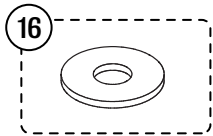
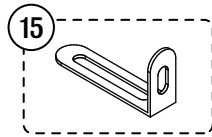
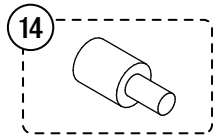
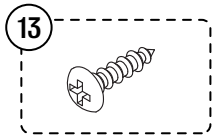
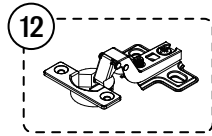
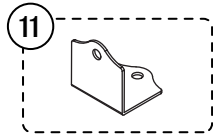
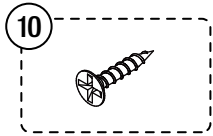
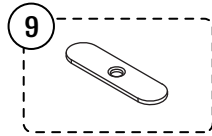
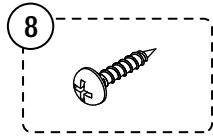
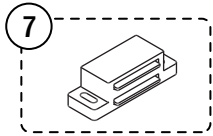
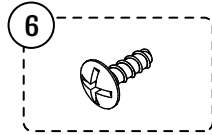
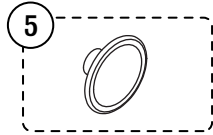
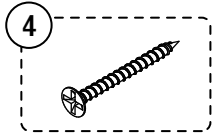
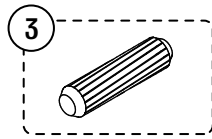
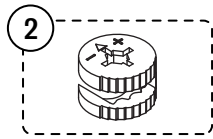
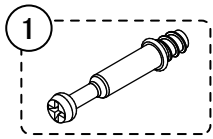

Nr	QTY	mm
1	22	Ø6x35
2	22	Ø15x12
3	26	Ø8x30
4	10	Ø4x35
5	2	
6	2	Ø4x14
7	2	
8	8	
9	2	
10	22	Ø3x12
11	2	20x20x20
12	4	Ø26
13	40	
14	8	
15	2	
16	4	
17	8	
18	6	

# Montering

Följ instruktionerna steg för steg

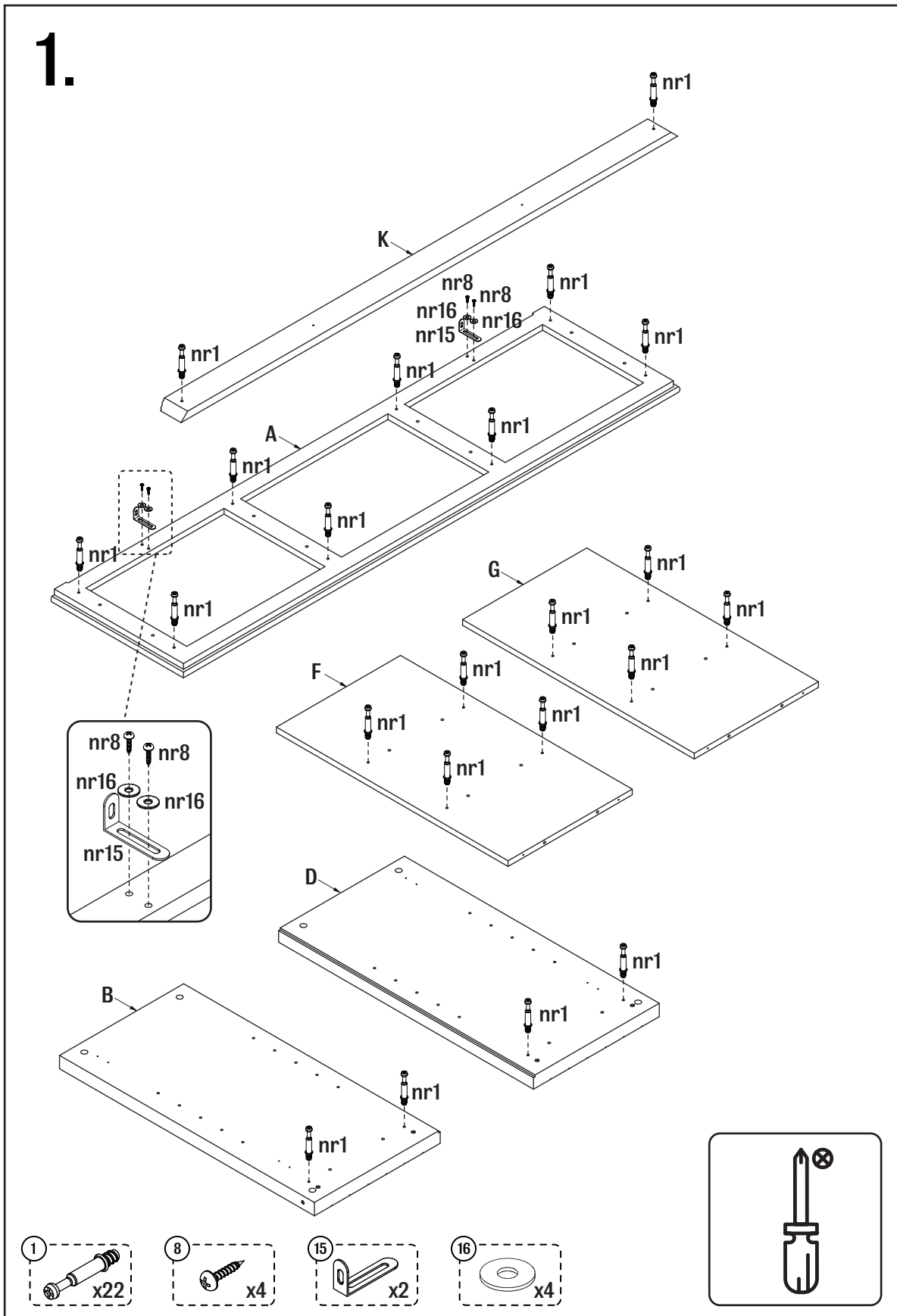

# 2.

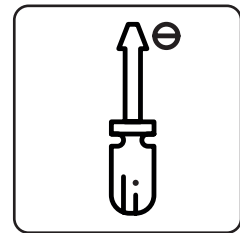
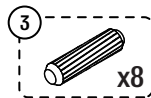
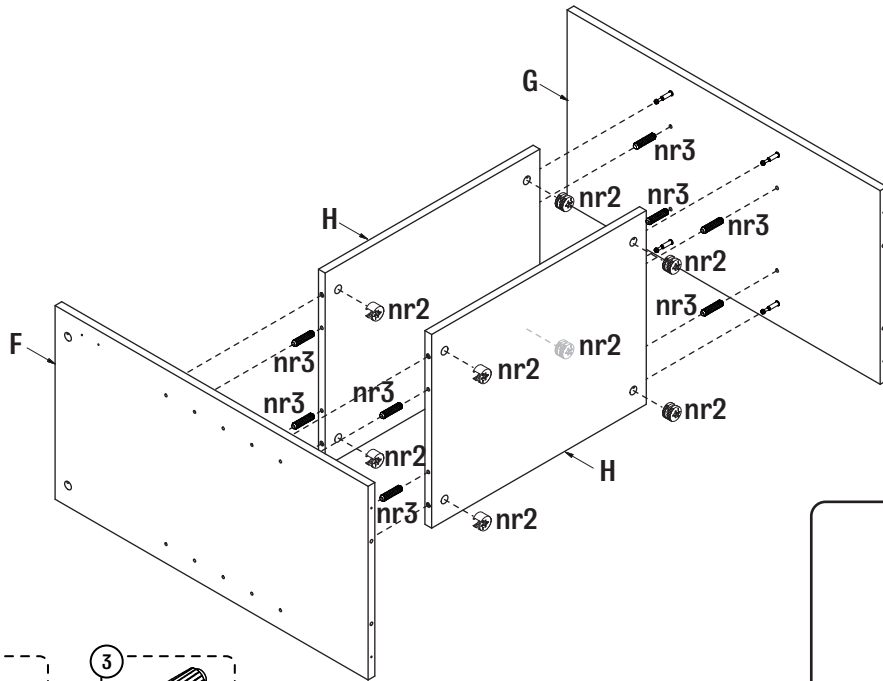

# 3.

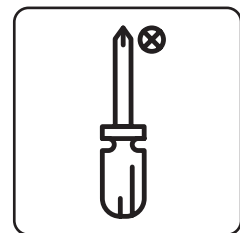
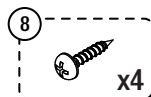
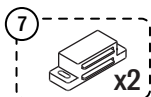
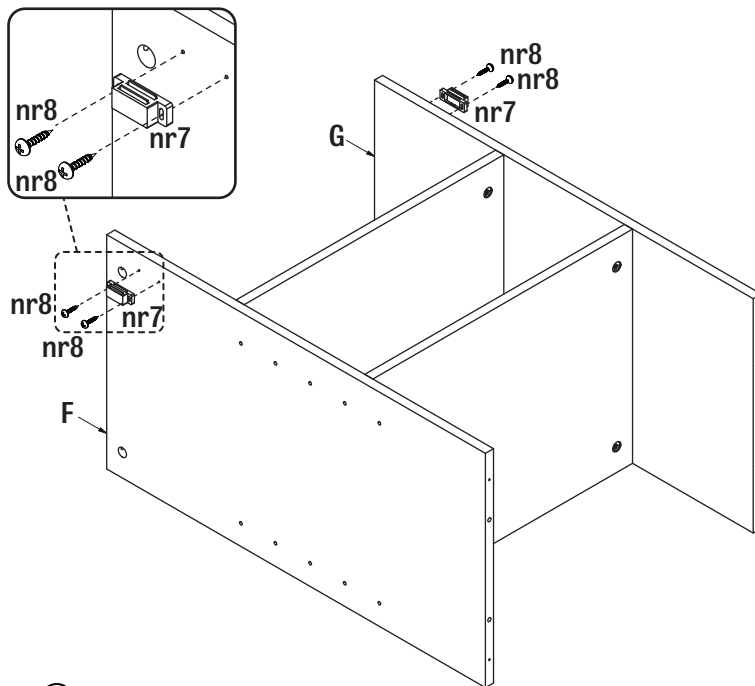

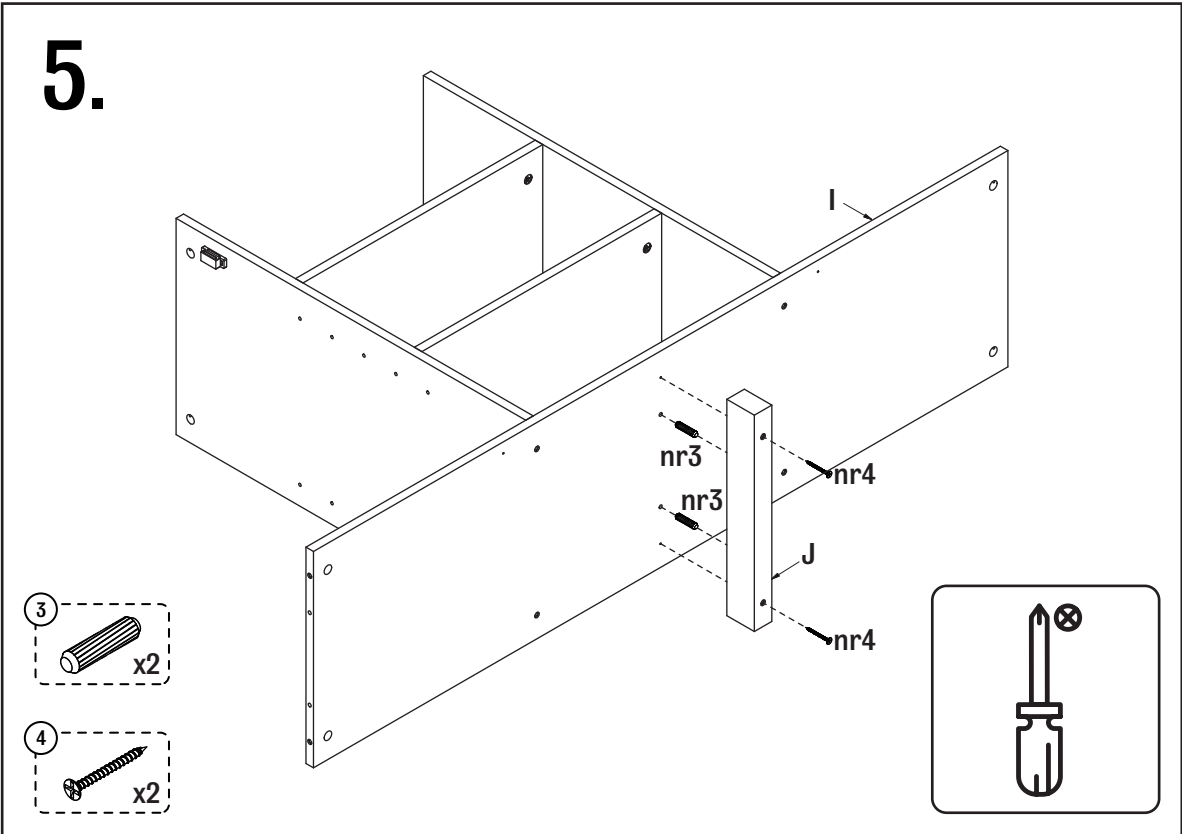
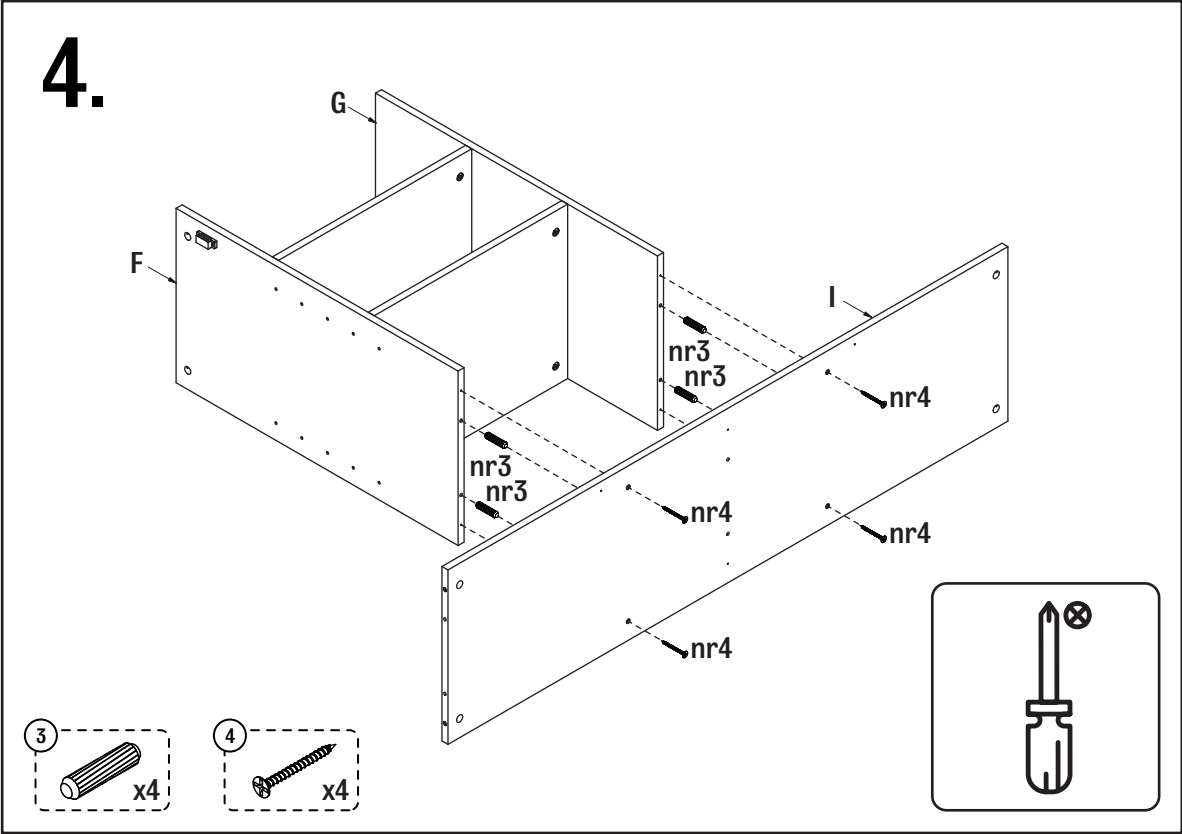

# 6.

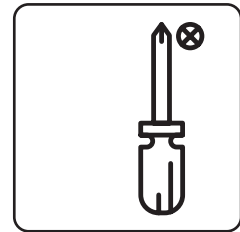
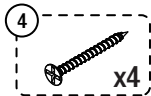
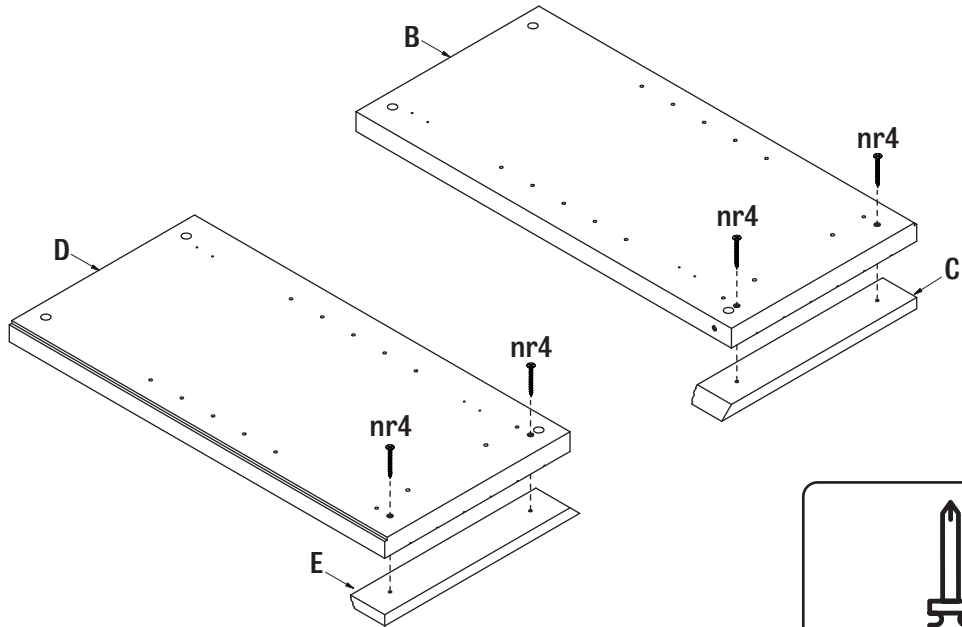

# 7.

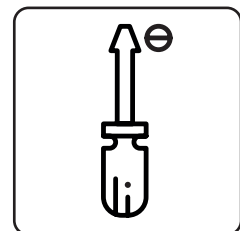
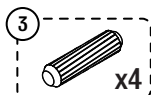
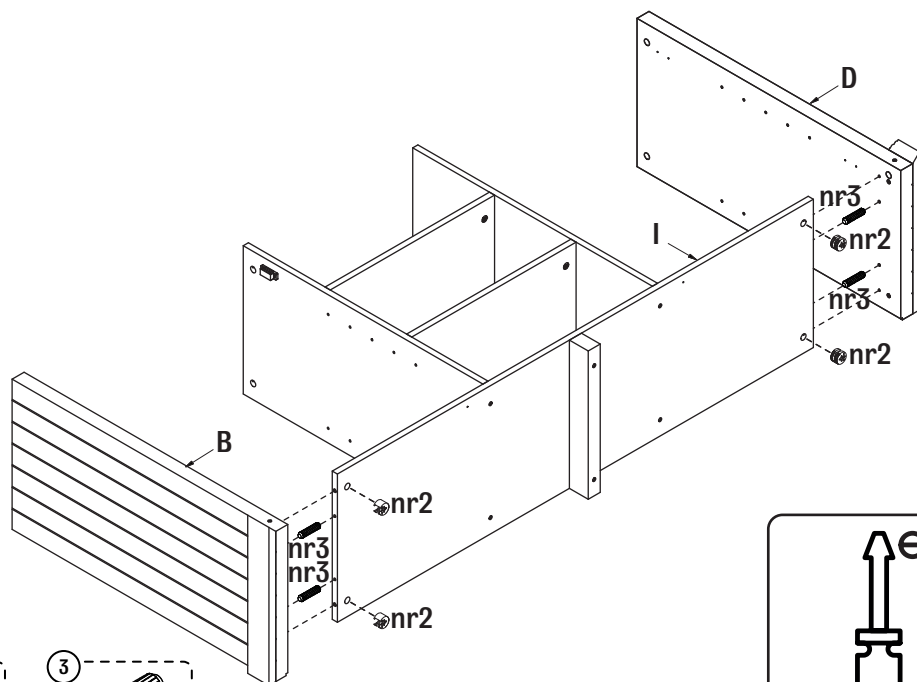



# 8.

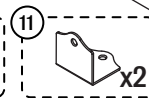
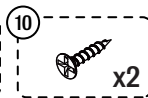
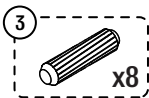
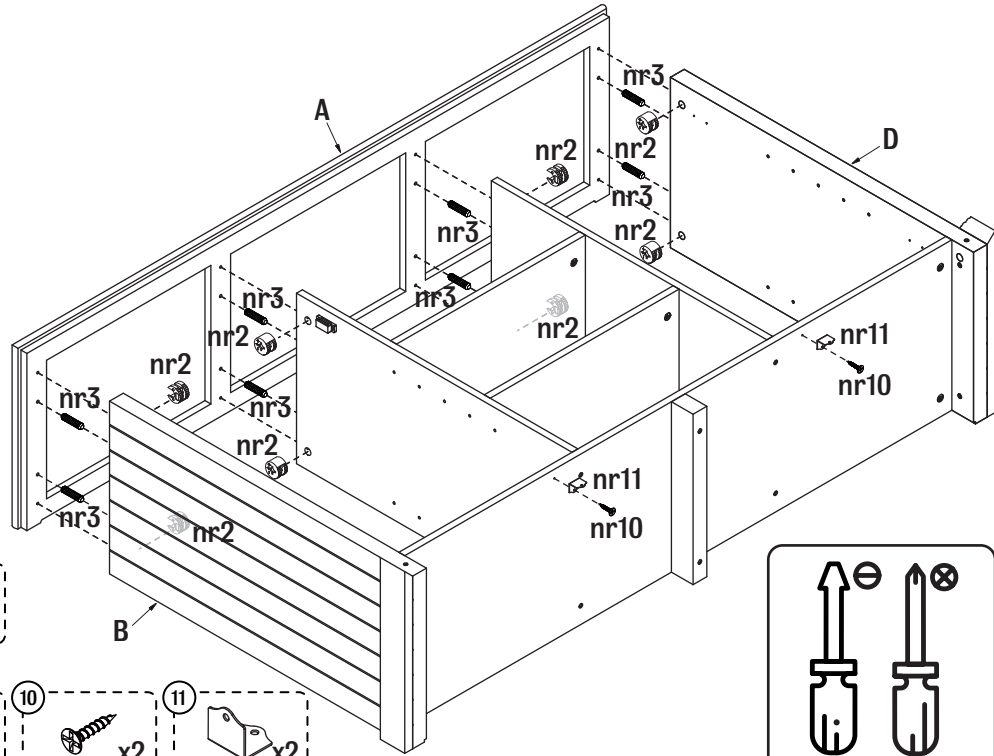

# 9.

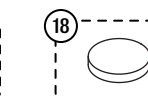
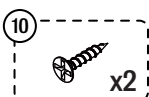
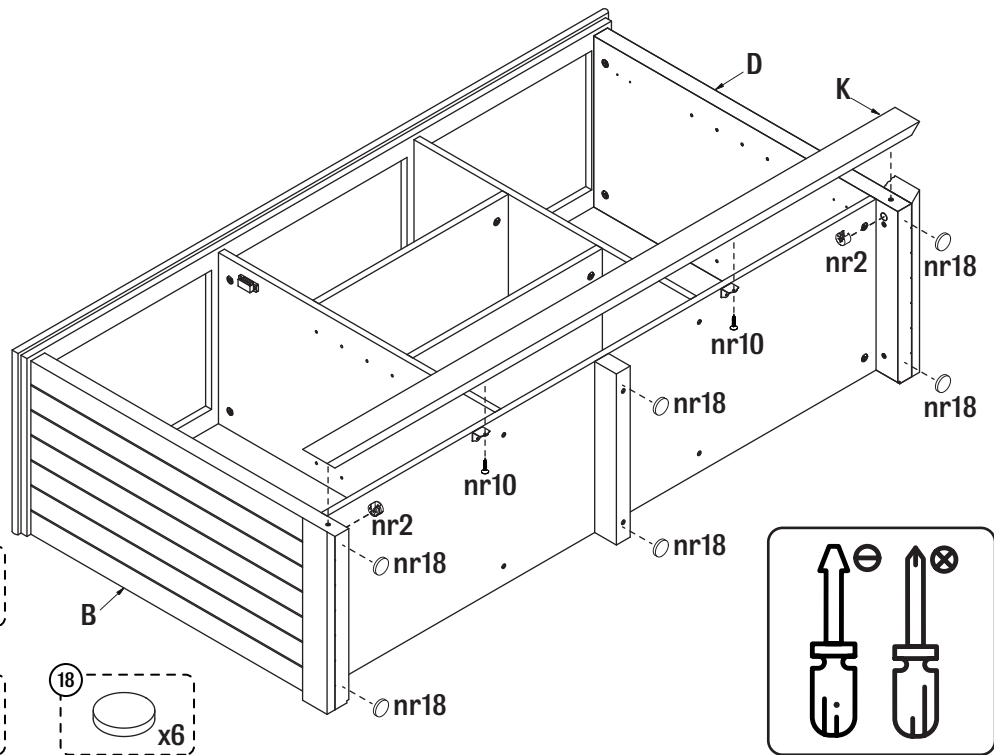

# 10.

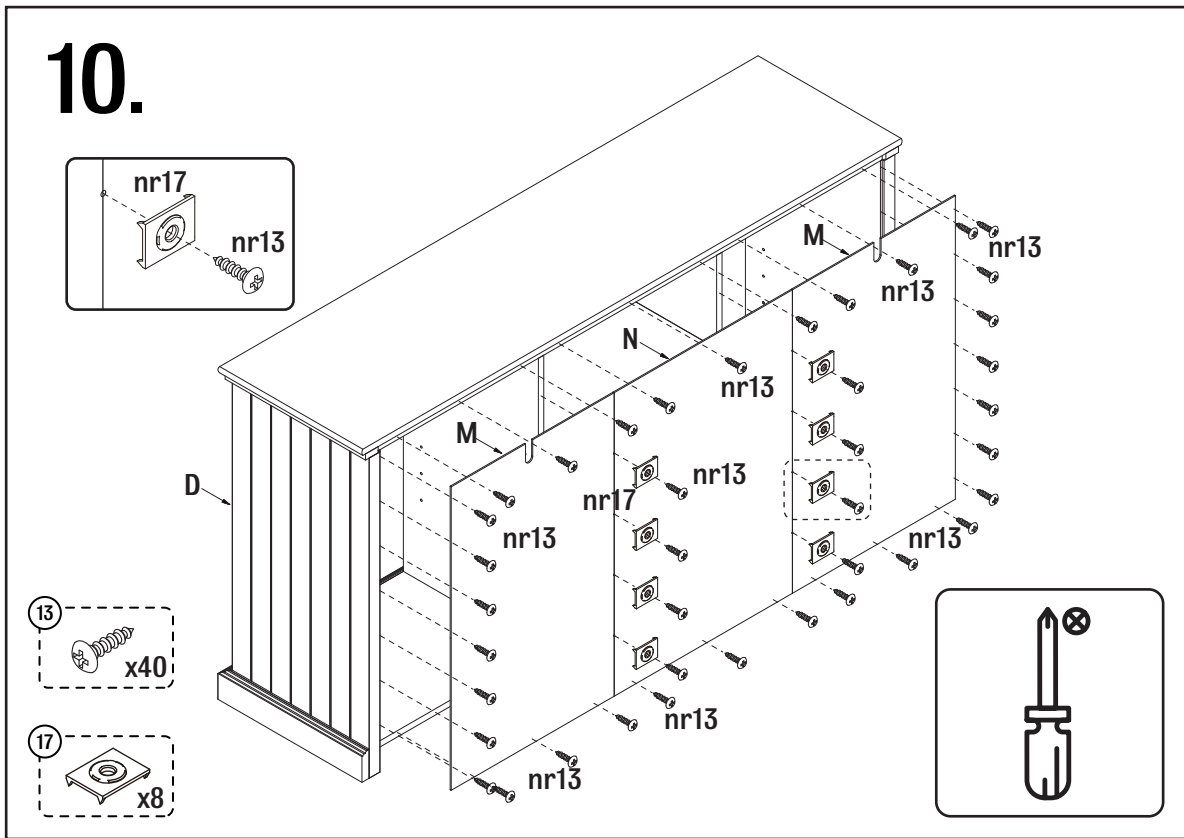

# 11.

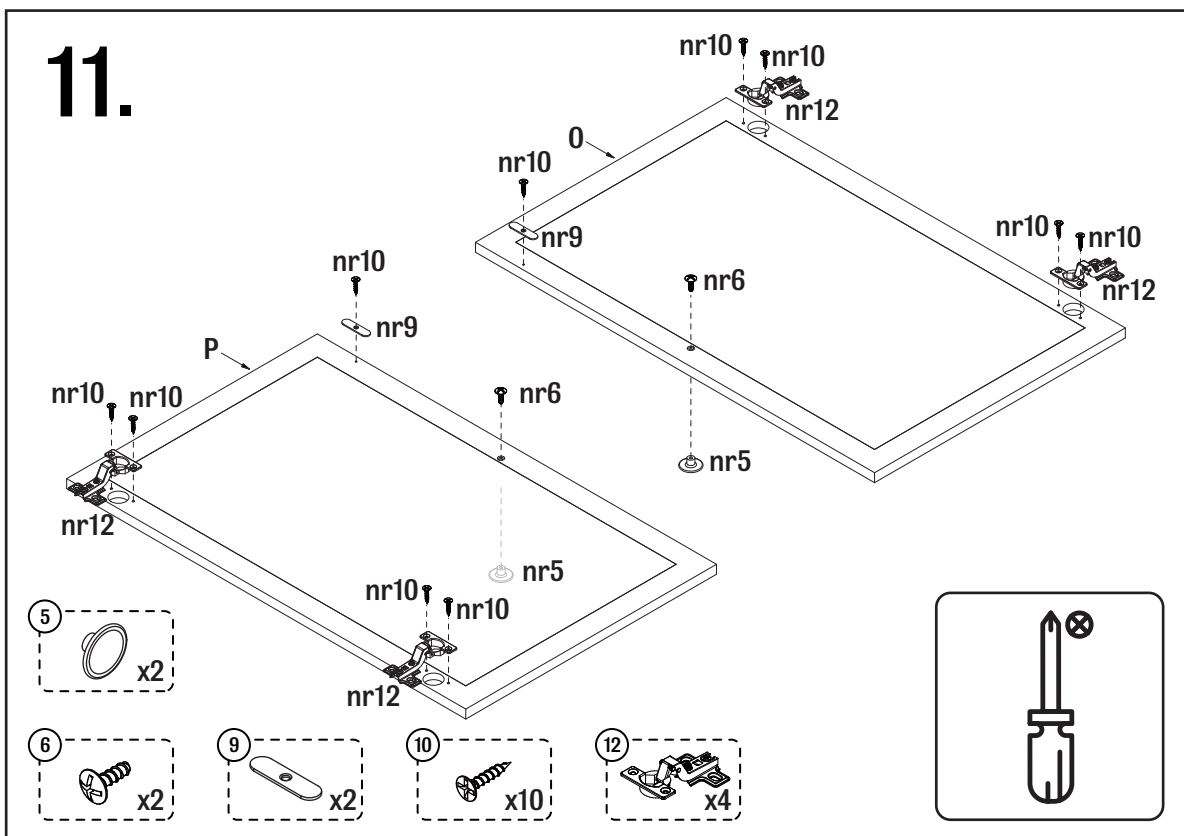

# 12.

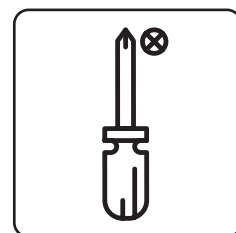
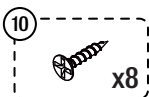
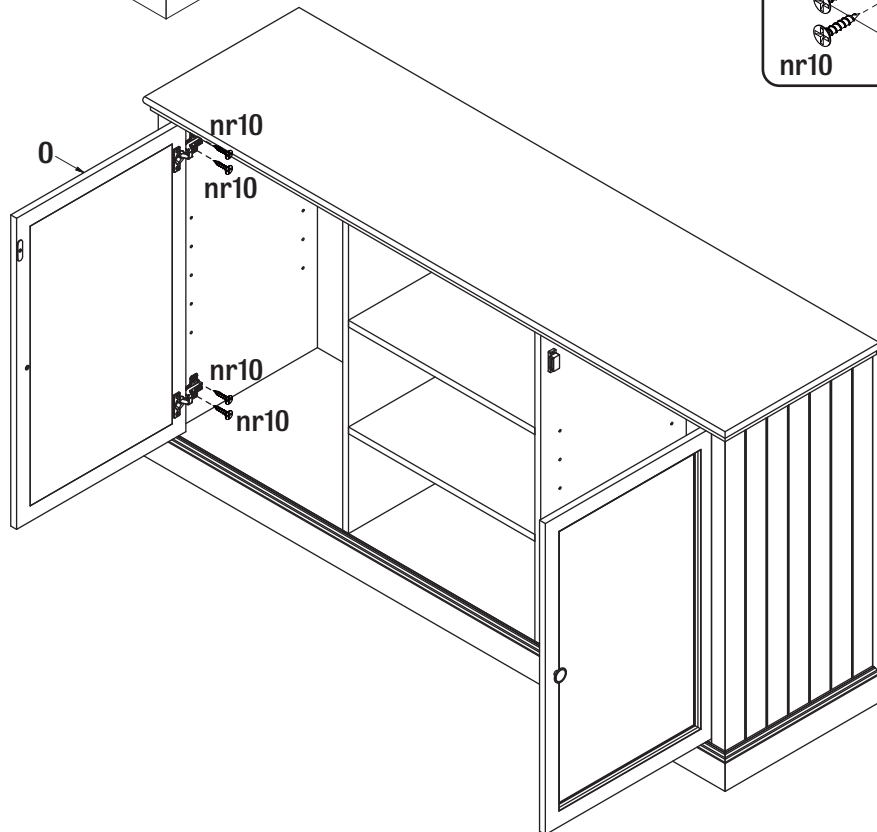
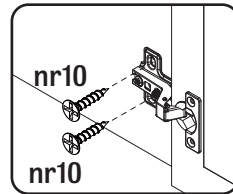
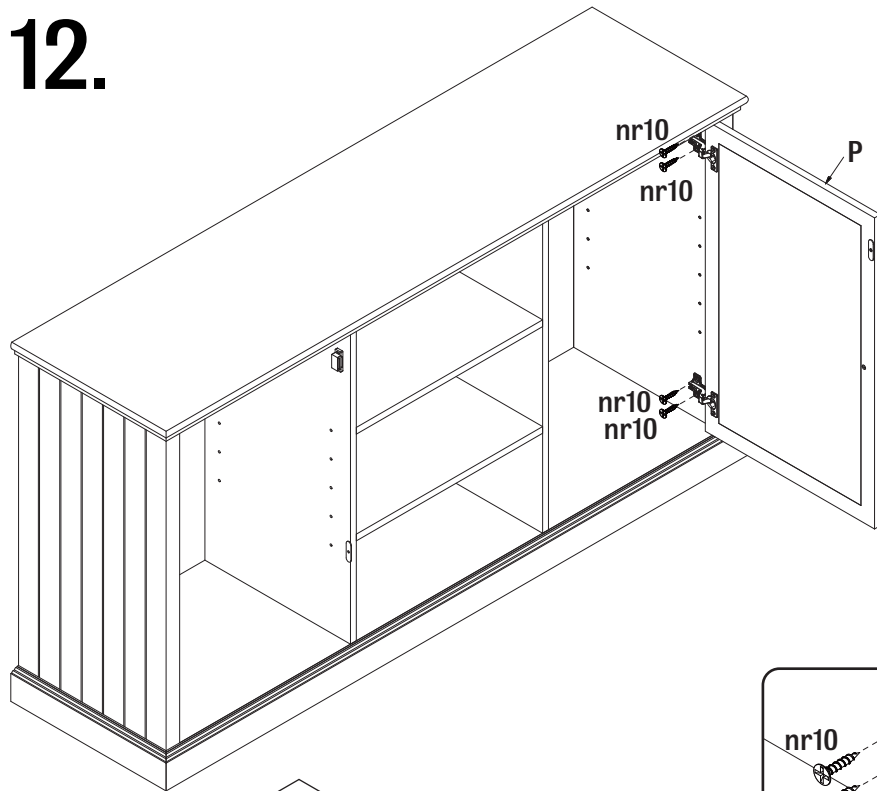

13.

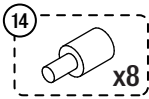
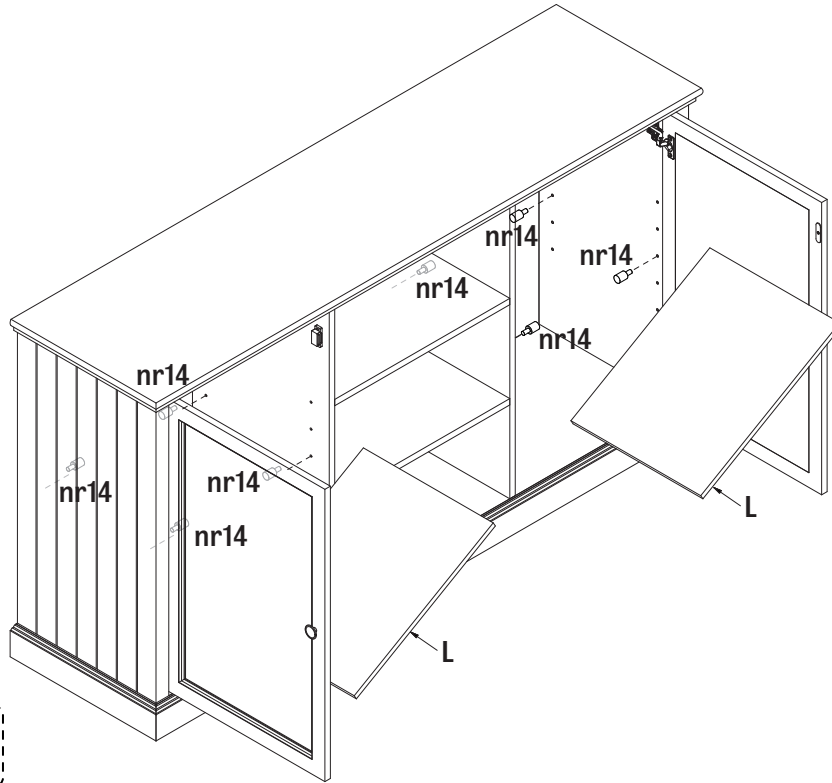

14.

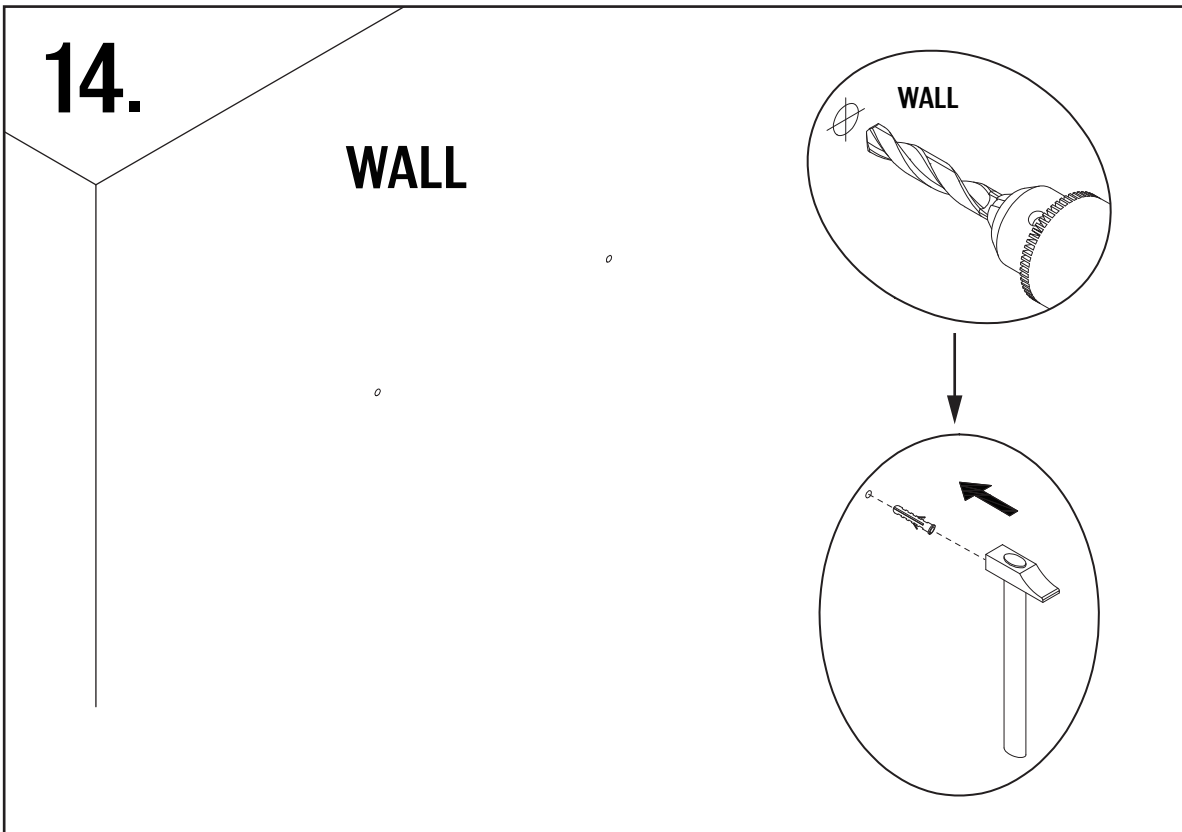

# 15.

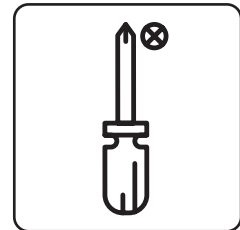
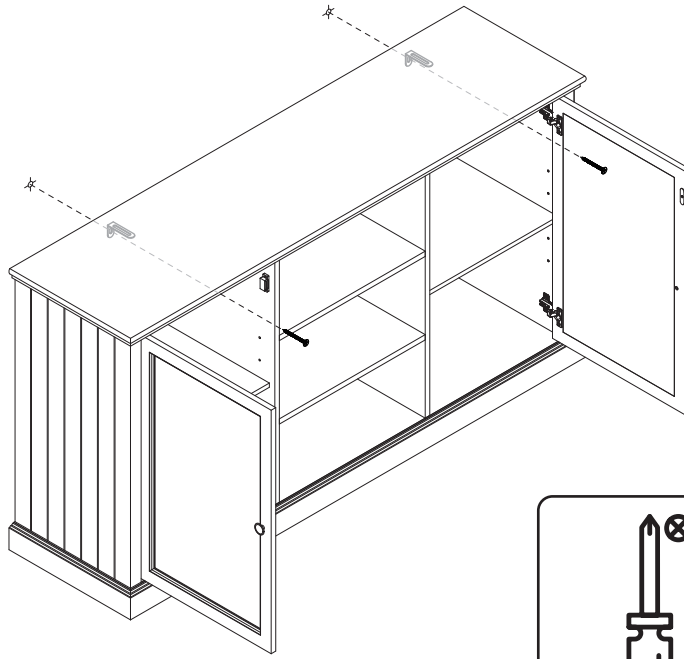
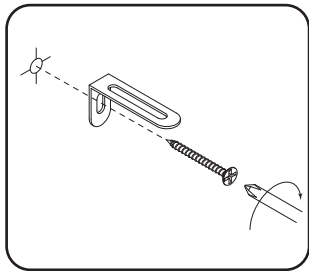

**Maxvikt**

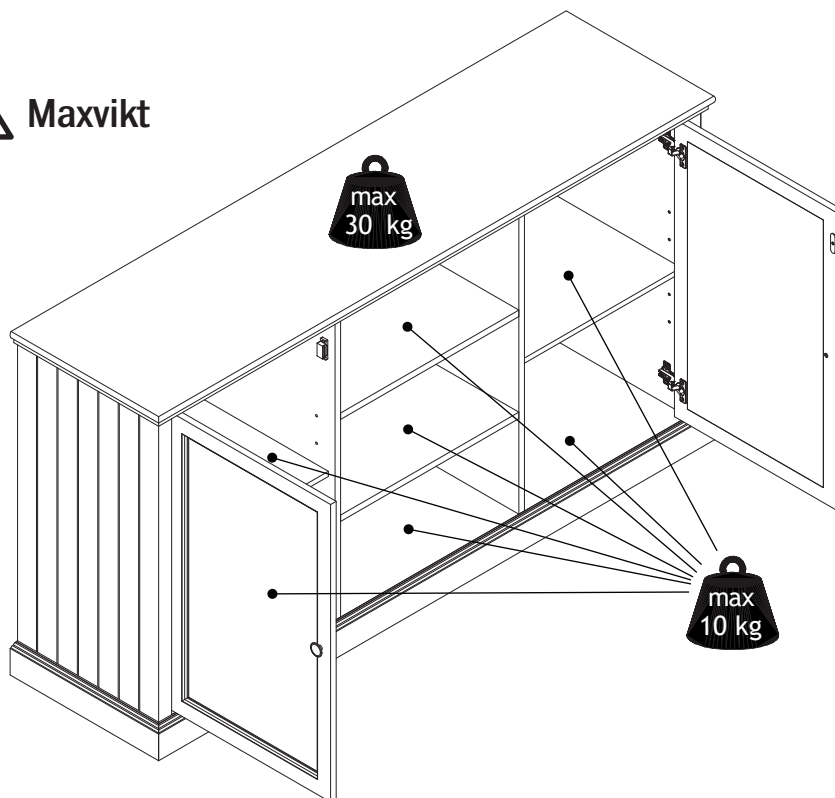

# INRED SNYGGT OCH TRYGGT!

Det är viktigt att känna sig trygg i sitt hem, särskilt när man har barn. Varje år sker många olyckor orsakade av välvtande möbler – olyckor som enkelt hade kunnat undvikas.

Här är några sätt att säkra din nya möbel från att tippa:



En form av tipskydd; band som skruvas fast i väggen

## Förankra

alltid möbelen i väggen. Använd tipskyddet som följer med möbelen (alla möbler som är mer än 75 cm höga bör levereras med tipskydd). Se monteringsanvisningen och utgå från den typ av vägg du har.

## Förhindra

att ett barn klättrar på möbelen, eller på annat sätt hänger på den.

## Förvara

tunga föremål så långt ner som möjligt, aldrig i möbels övre delar. Tänk på att alla möbler inte är gjorda för att bära upp t ex tunga teveapparater – för dessa finns speciella mediamöbler.

# VILKEN SKRUV SKA ANVÄNDAS?

1. **Gipsvägg med träreglar:** Fäst skruven direkt i regeln.
2. **Gipsvägg utan träreglar:** Använd plugg med skruv.
3. **Massiv betongvägg:** Använd plugg med skruv.
4. **Ihålrig betongvägg:** Använd vikplugg/expander.

1.

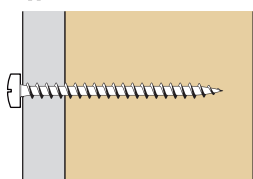

Träskruv

2.

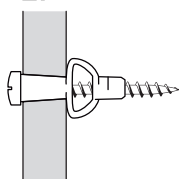

Plugg med skruv

3.

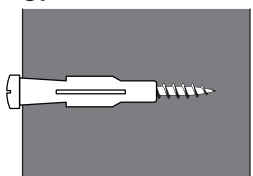

Plugg med skruv

4.

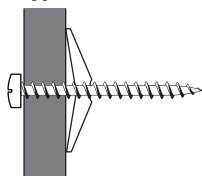

Vikplugg/expander med skruv



En form av tipskydd; vinkeljärn

Är du osäker på vilka skruvar du ska använda, kontakta alltid en bygghandel eller järnaffär.

