

# Monteringsanvisning

# Madeira

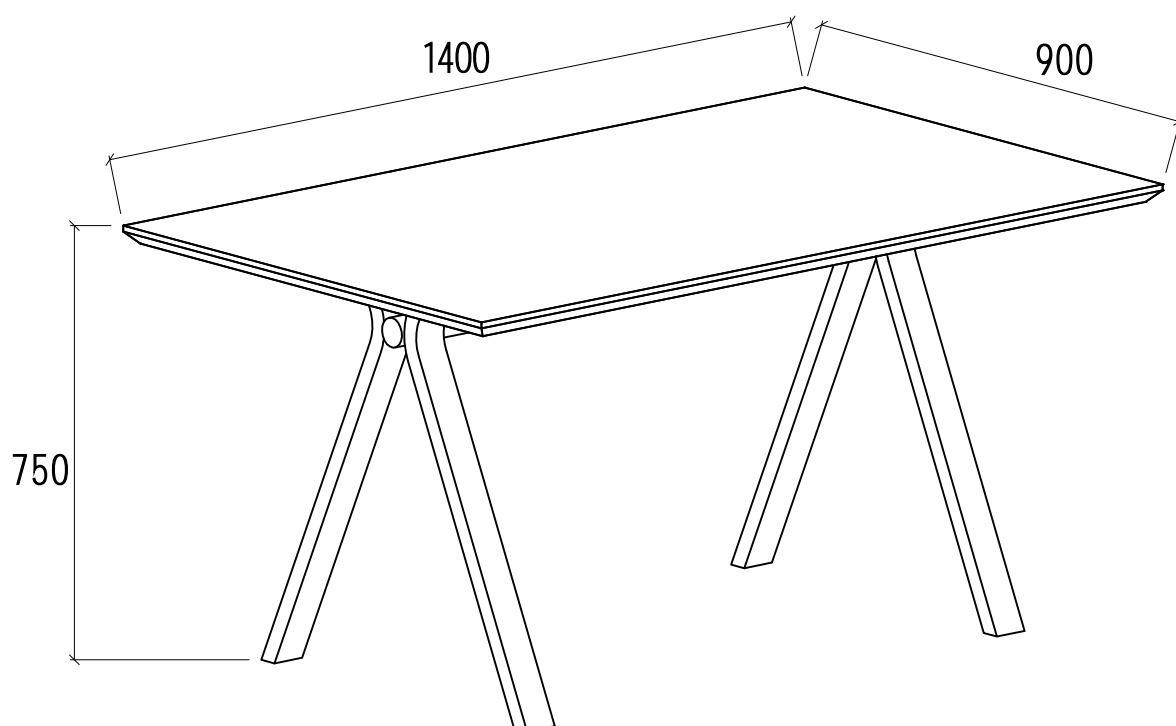

# Du behöver



ca 20 minuter

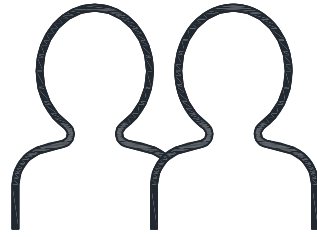

2 personer

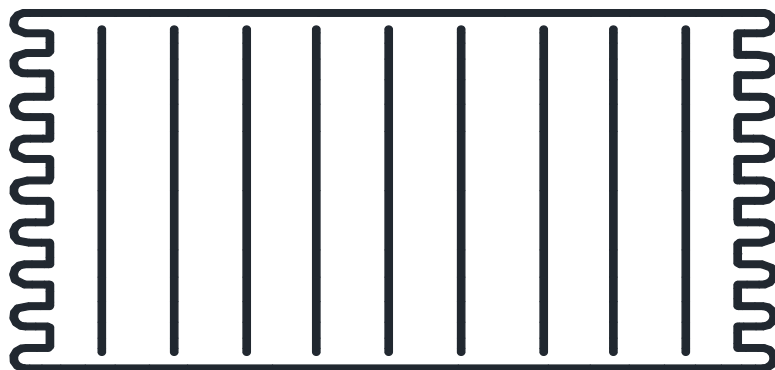
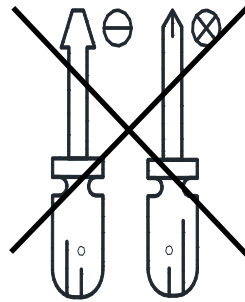
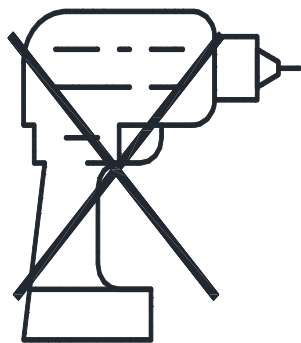

Lägg din produkt på ett mjukt underlag när du monterar



Har du frågor om monteringen av dina möbler?  
Hör av dig till din Mio-butik eller ring till vår kundservice 020 66 44 00

# Ingående delar

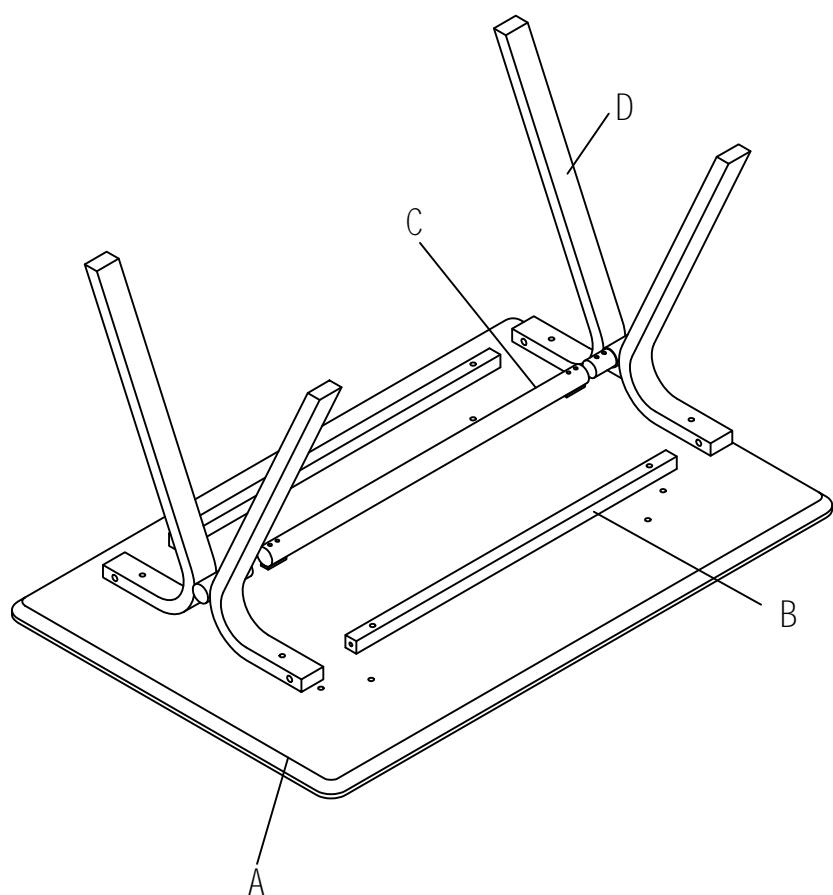

	QTY	mm
A	1	1400*900*30
B	2	30*30*880
C	1	ø42*872
D	2	720*660*60

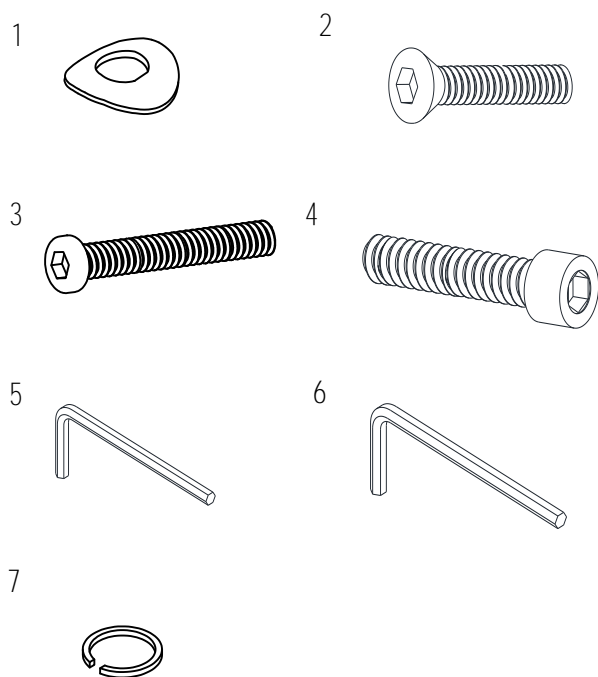

Nr	QTY	mm
1	4	Ø22*2
2	8	M8*50
3	4	M8*50
4	4	M8*75
5	1	M5
6	1	M6
7	4	Ø12*1.5

# Montering

Följ instruktionerna steg för steg

1

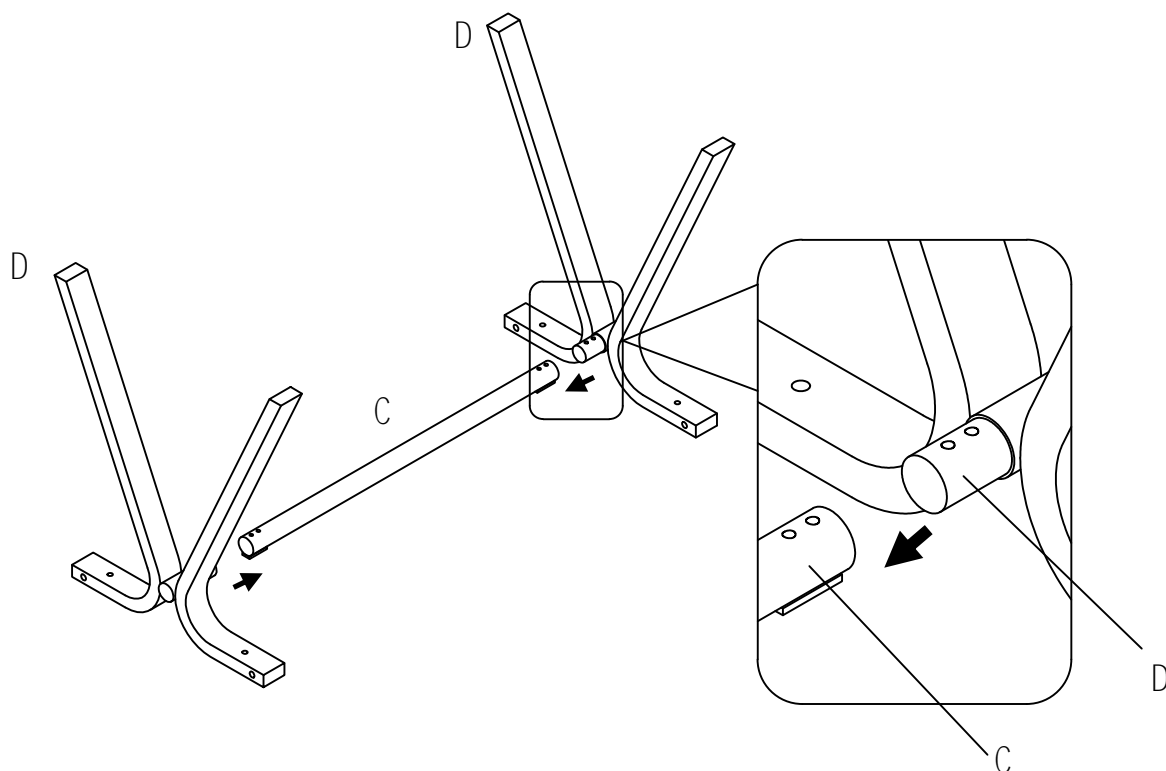

2

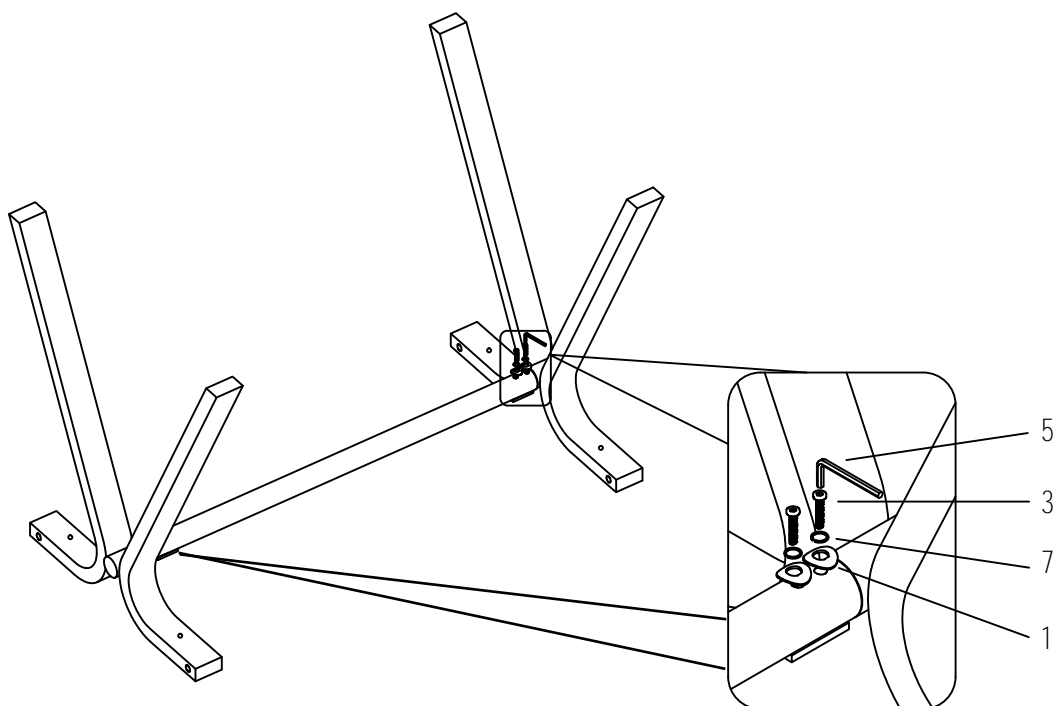

Nr. 1 x 4



Nr. 3 x 4



Nr. 5 x 1



Nr. 7 x 4



# 3

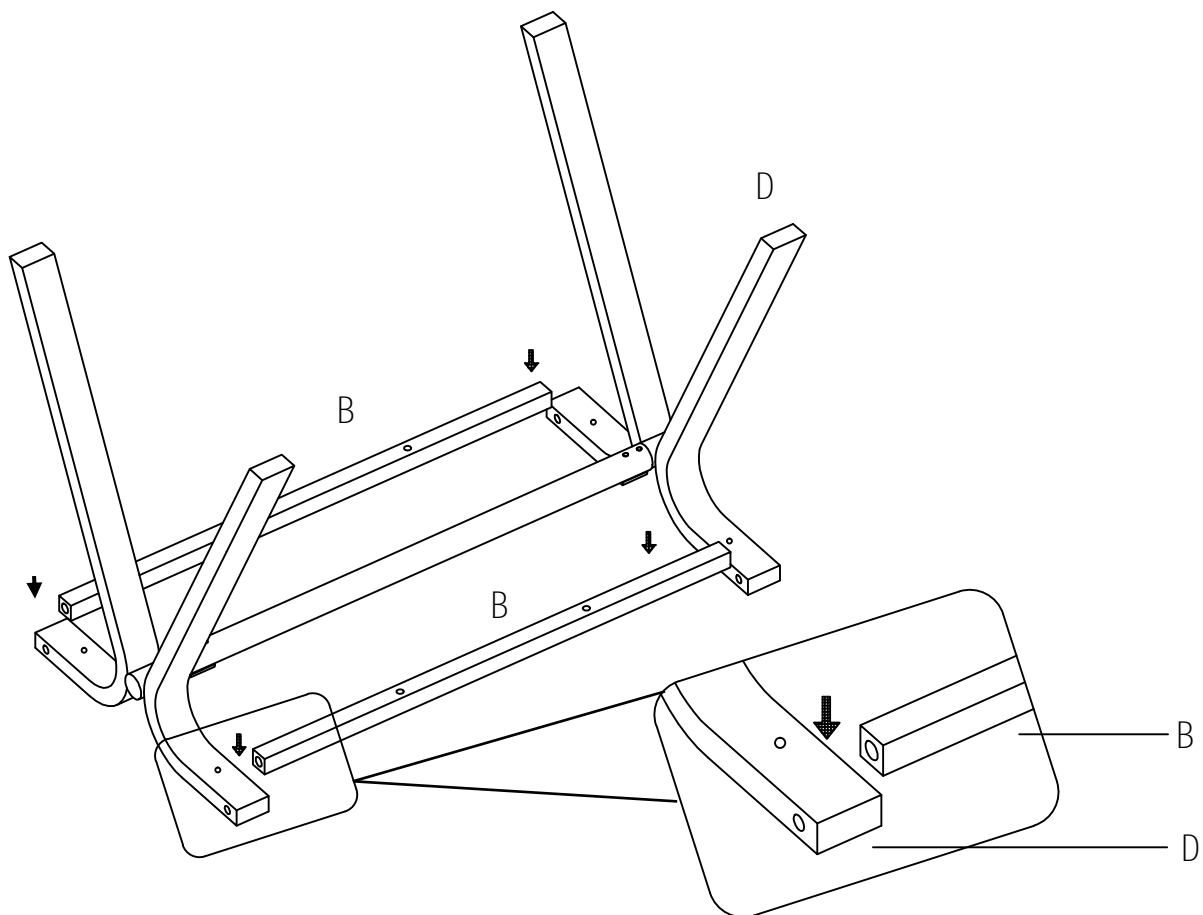

# 4

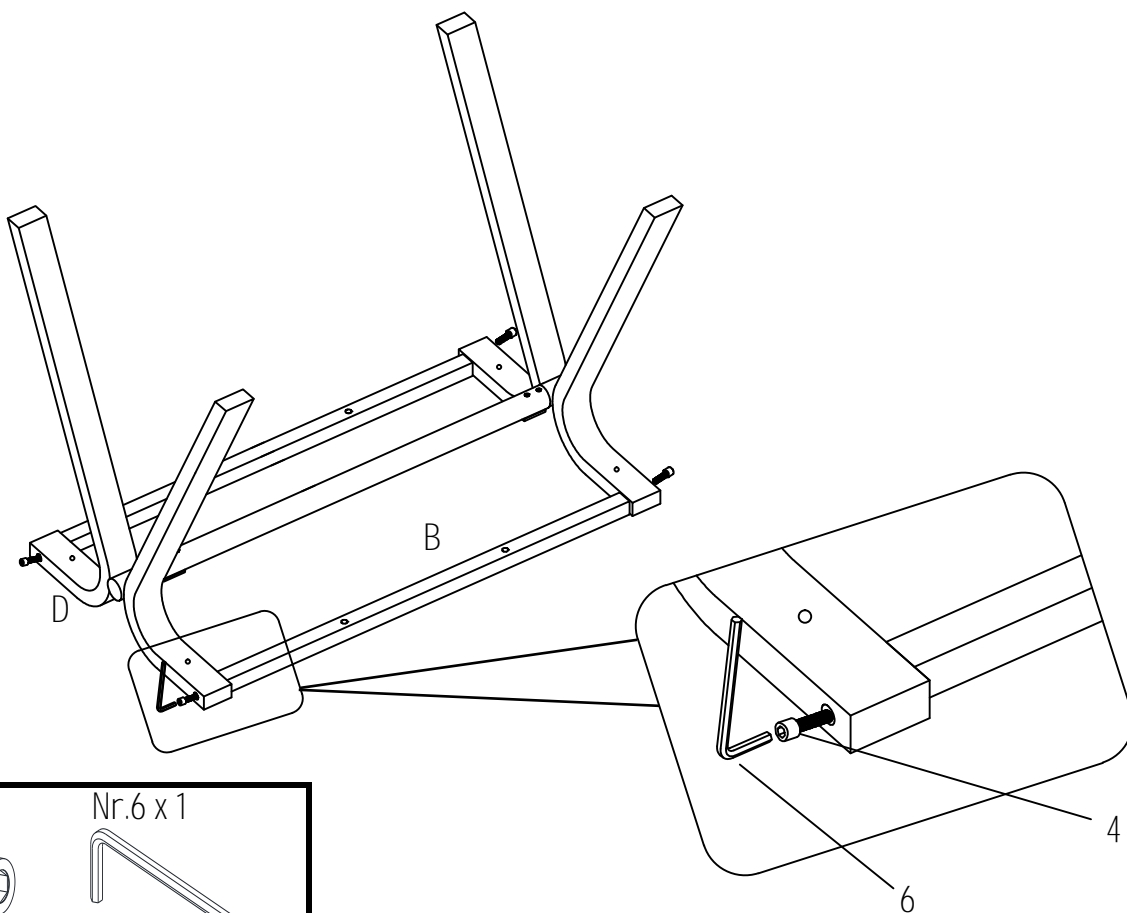

Nr.4 x 4

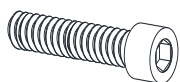

Nr.6 x 1

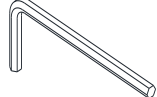

5

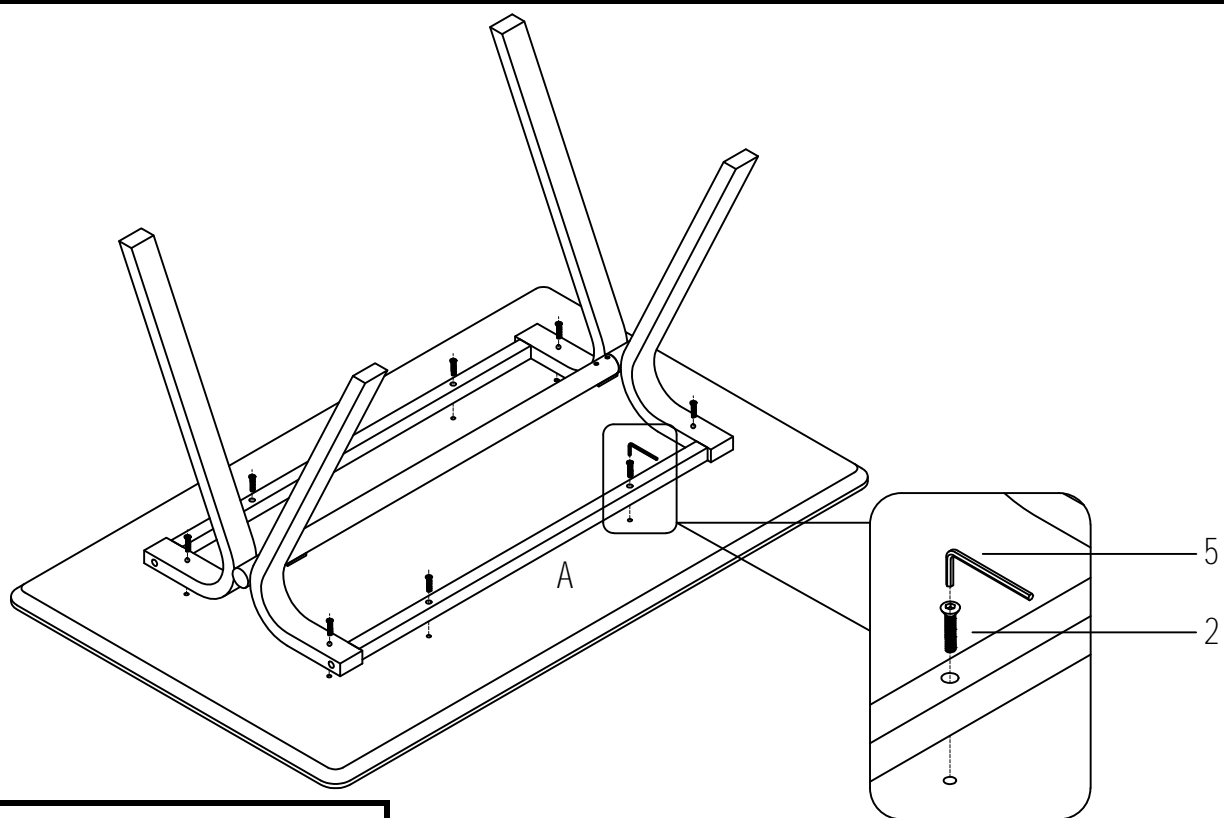

Nr. 2 x 8

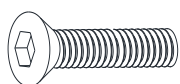

Nr. 5 x 1



6

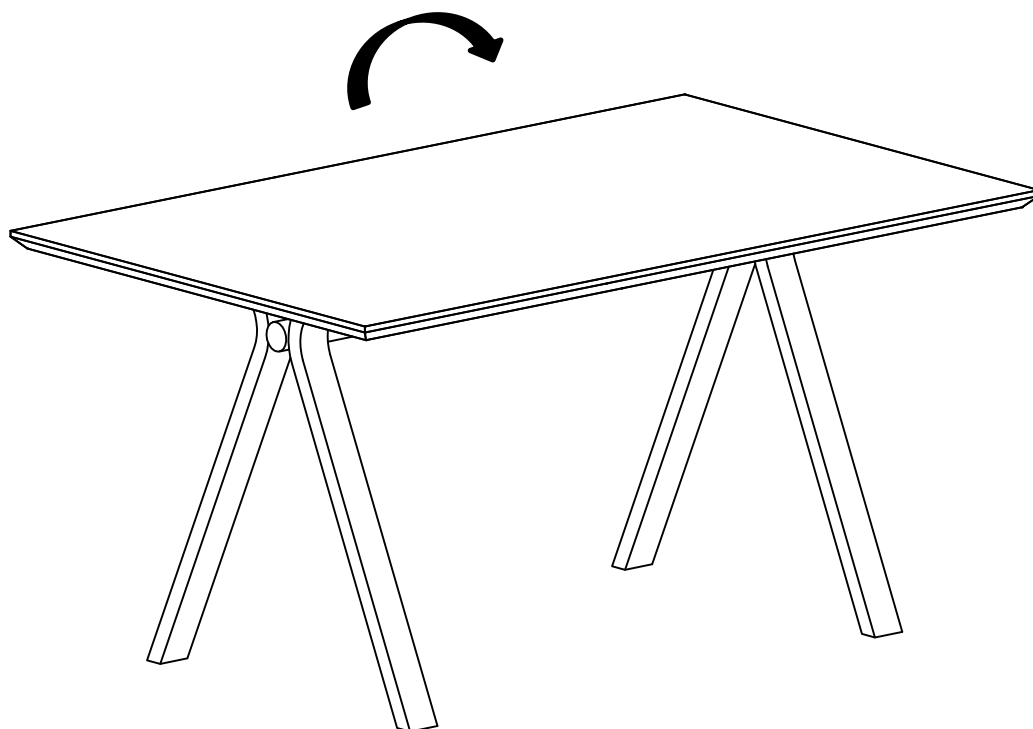



Maxvikt

