

# Monteringsanvisning

# Madeira

**mio**

# Du behöver

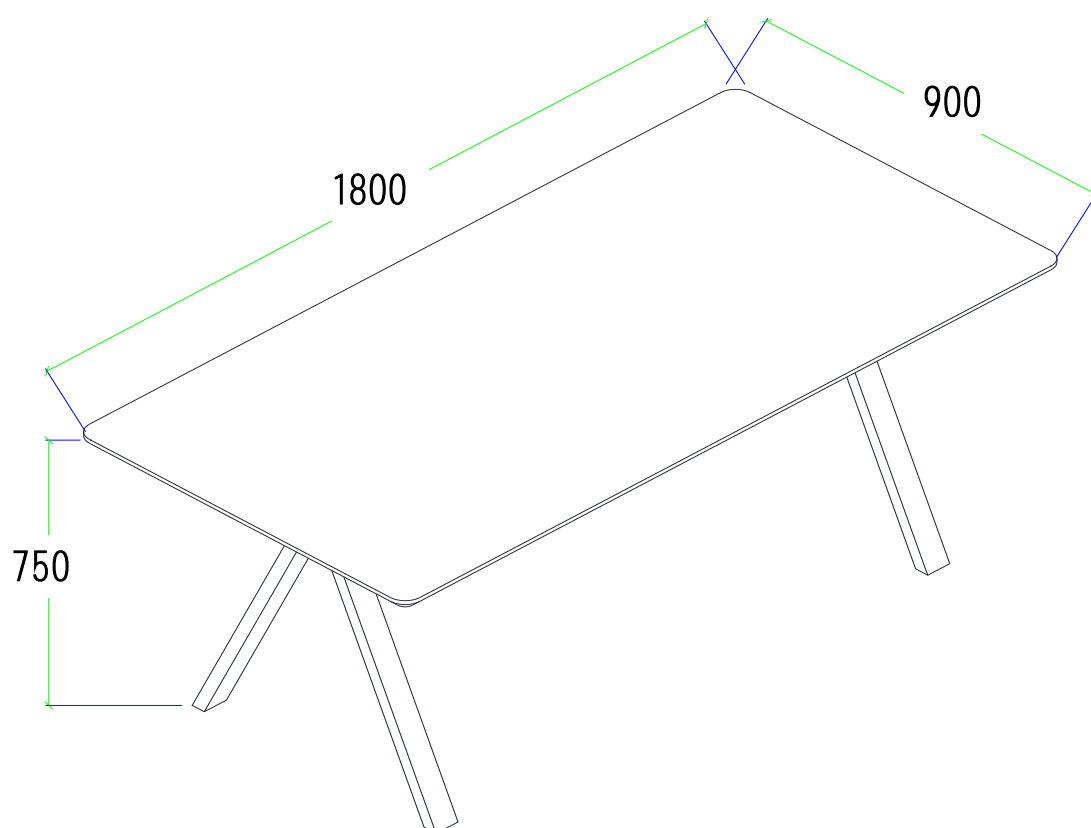

ca 20 minuter

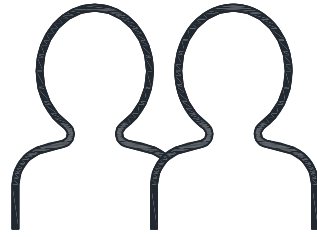

2 personer

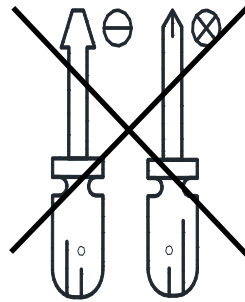
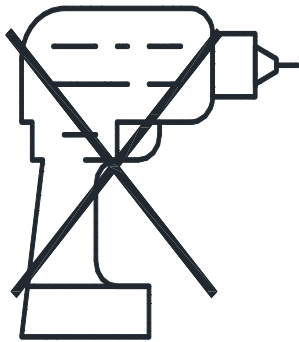

Lägg din produkt på ett mjukt underlag när du monterar



Har du frågor om monteringen av dina möbler?  
Hör av dig till din Mio-butik eller ring till vår kundservice 020 66 44 00

# Ingående delar

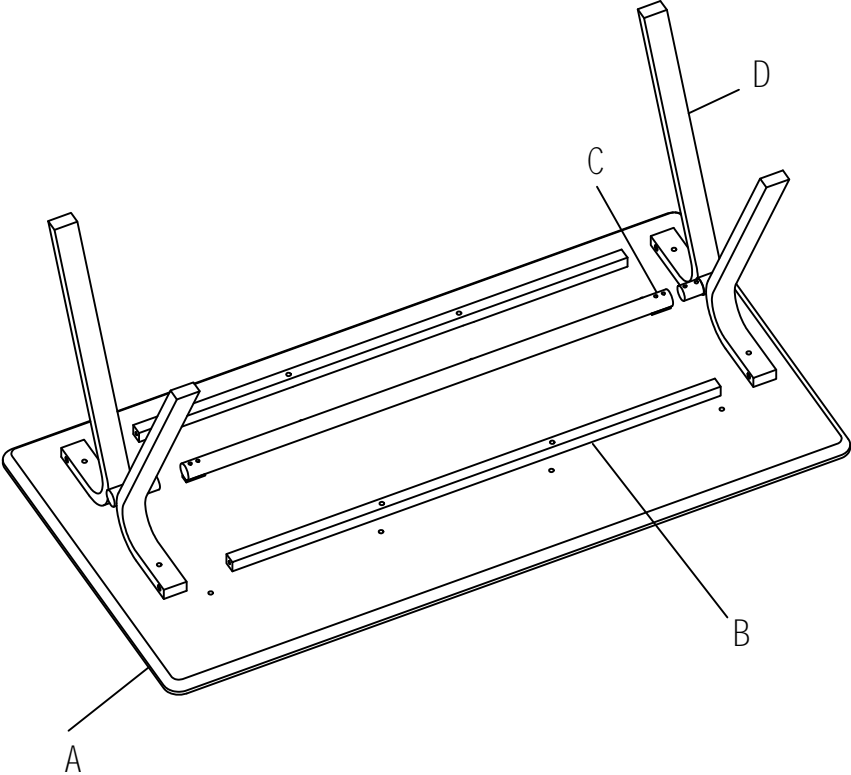

|   | QTY | mm          |
|---|-----|-------------|
| A | 1   | 1800*900*30 |
| B | 2   | 30*30*1280  |
| C | 1   | ø42*1272    |
| D | 2   | 720*660*60  |

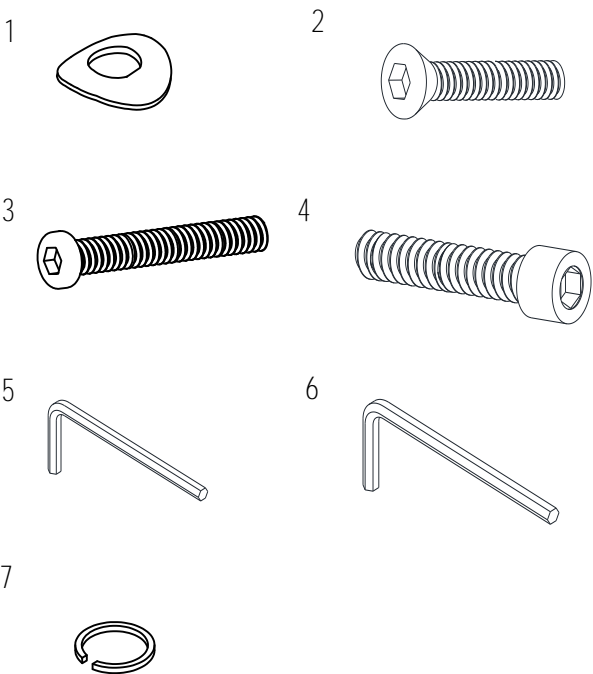

| Nr | QTY | mm      |
|----|-----|---------|
| 1  | 4   | Ø22*2   |
| 2  | 8   | M8*50   |
| 3  | 4   | M8*50   |
| 4  | 4   | M8*75   |
| 5  | 1   | M5      |
| 6  | 1   | M6      |
| 7  | 4   | Ø12*1.5 |

# Montering

Följ instruktionerna steg för steg

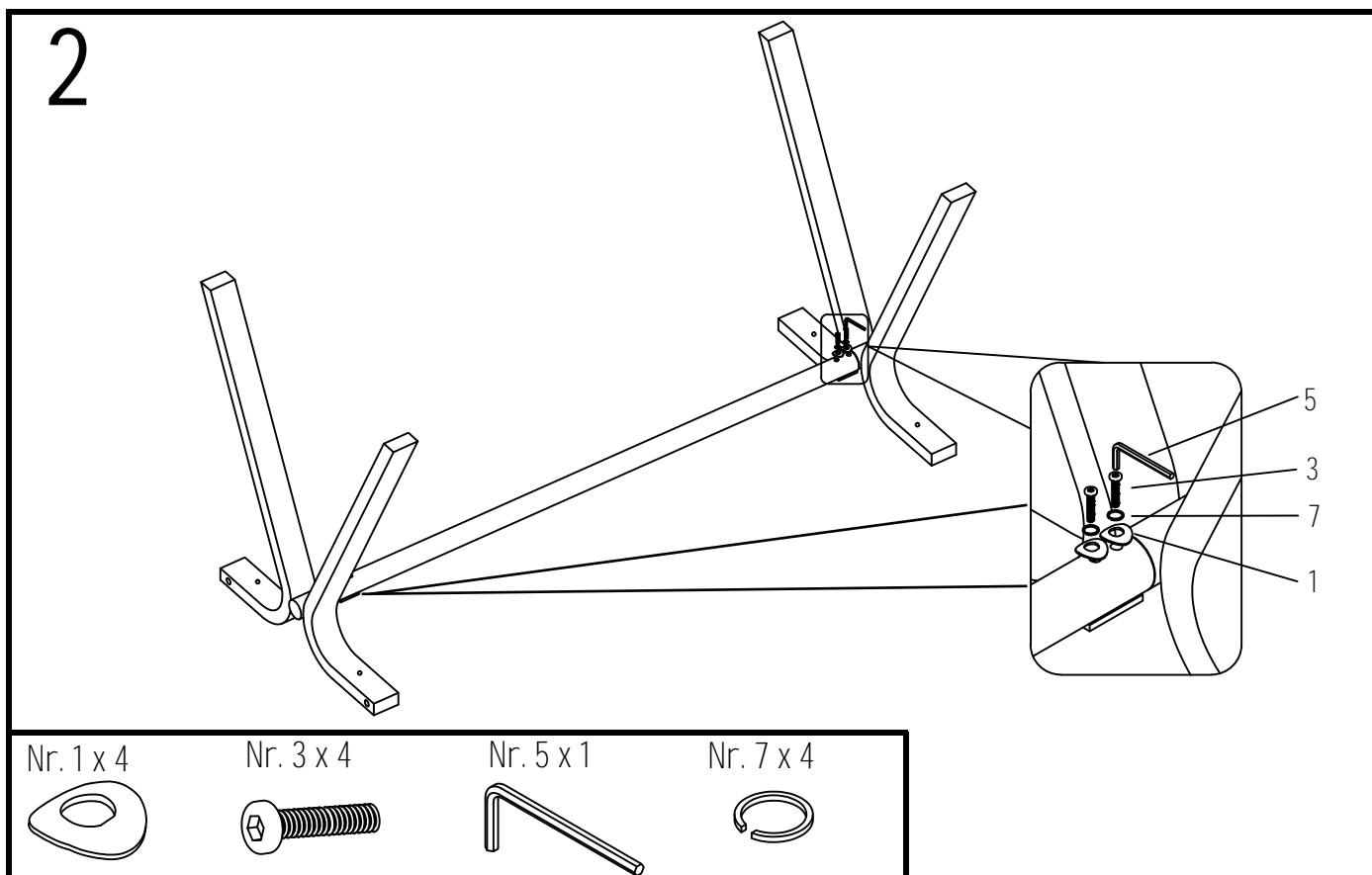
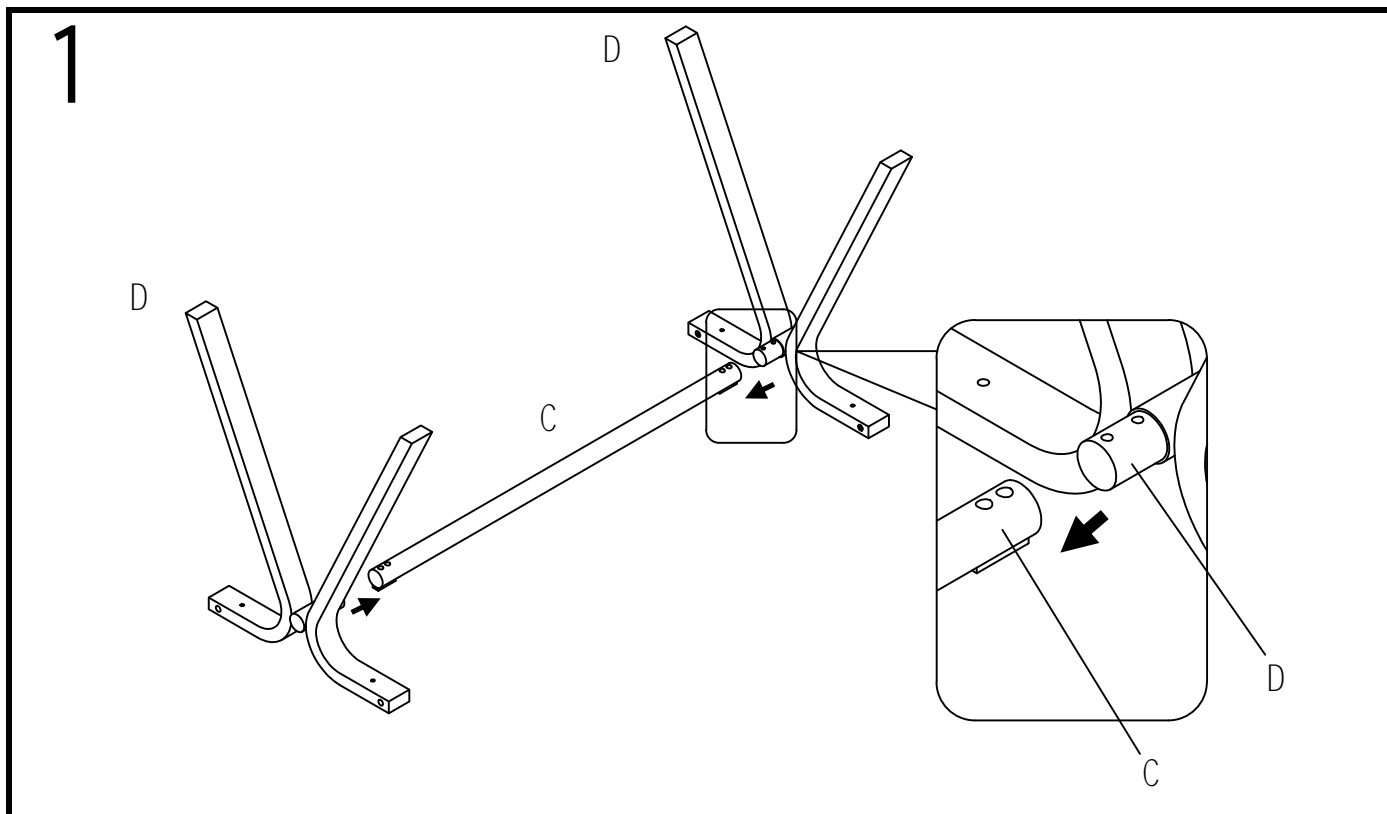

# 3

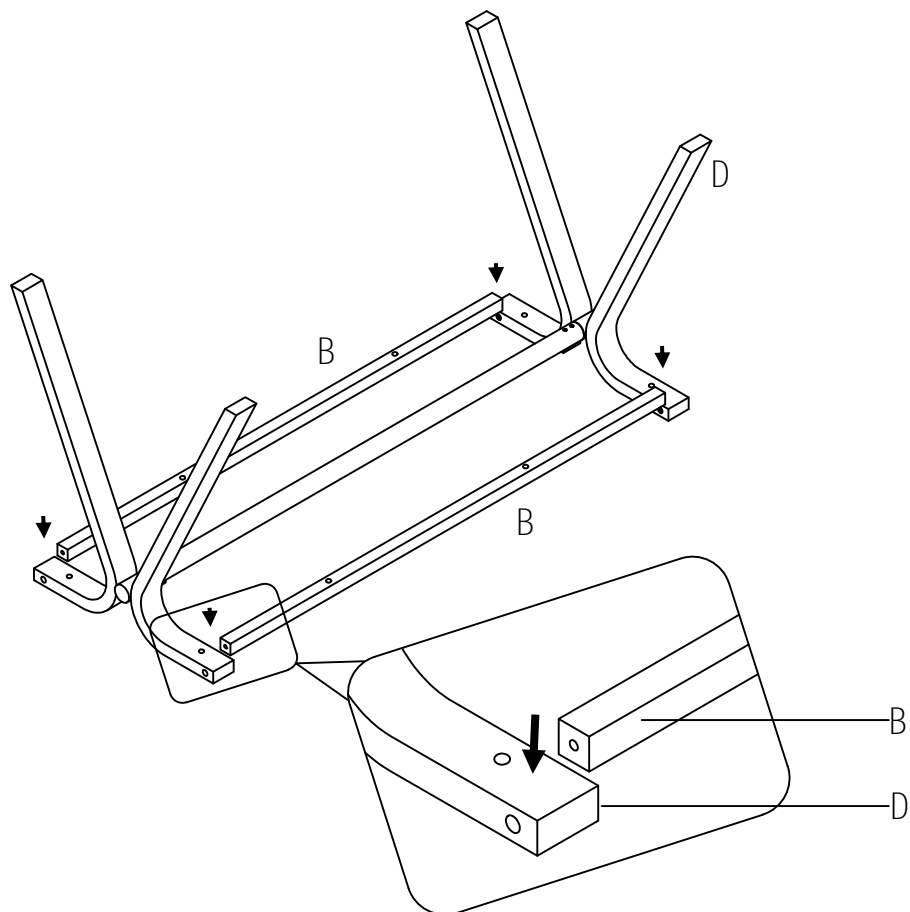

# 4

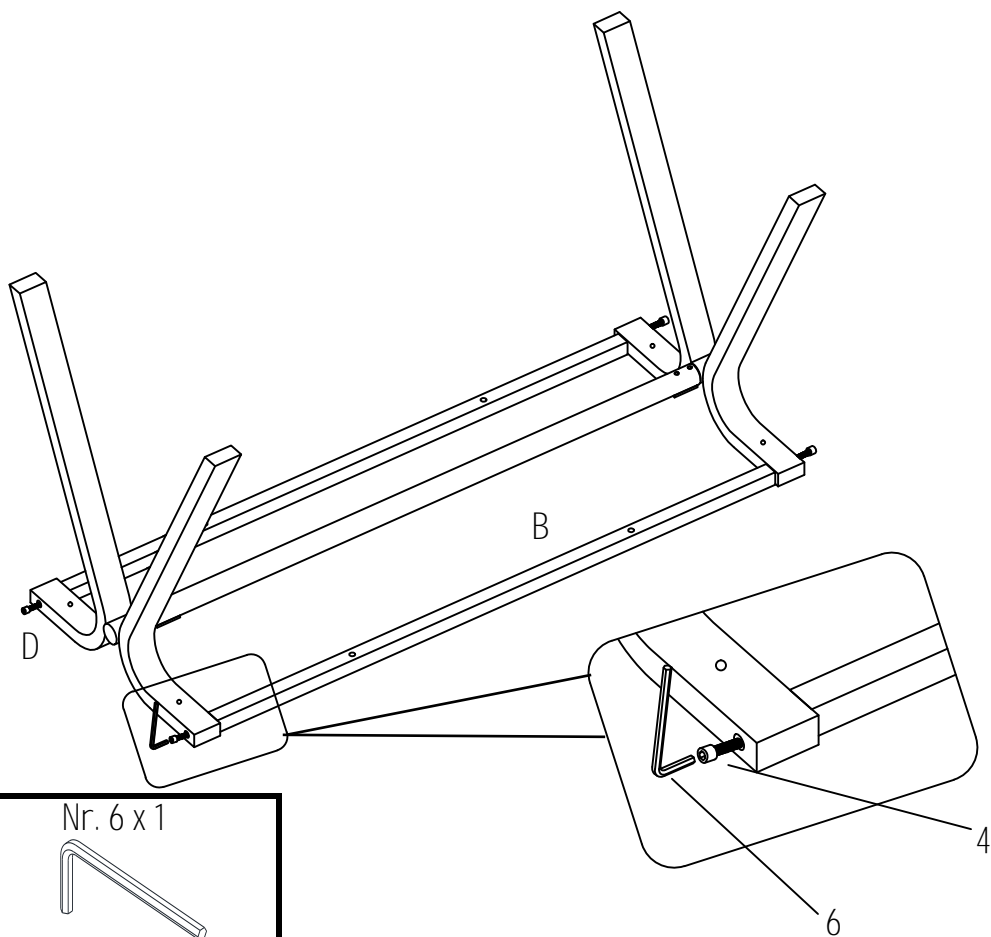

Nr. 4 x 4

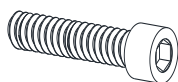

Nr. 6 x 1

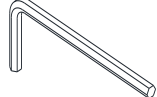

5

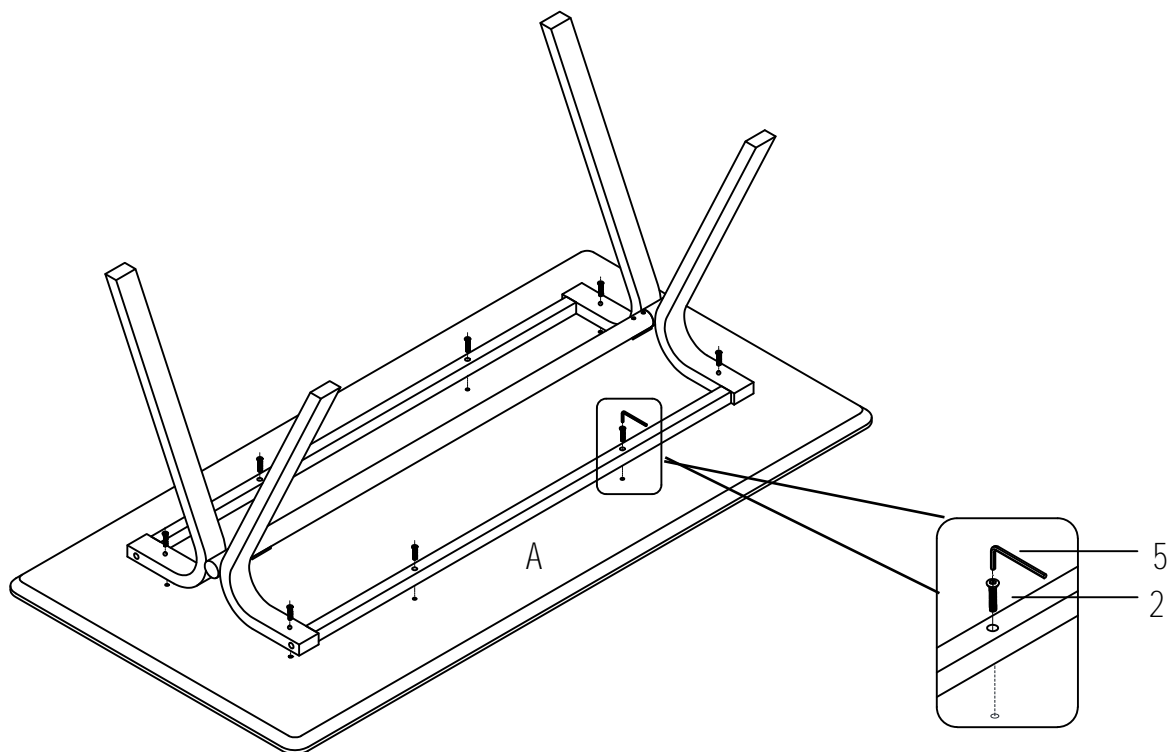

Nr. 2 x 8

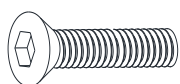

Nr. 5 x 1

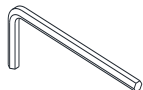

6

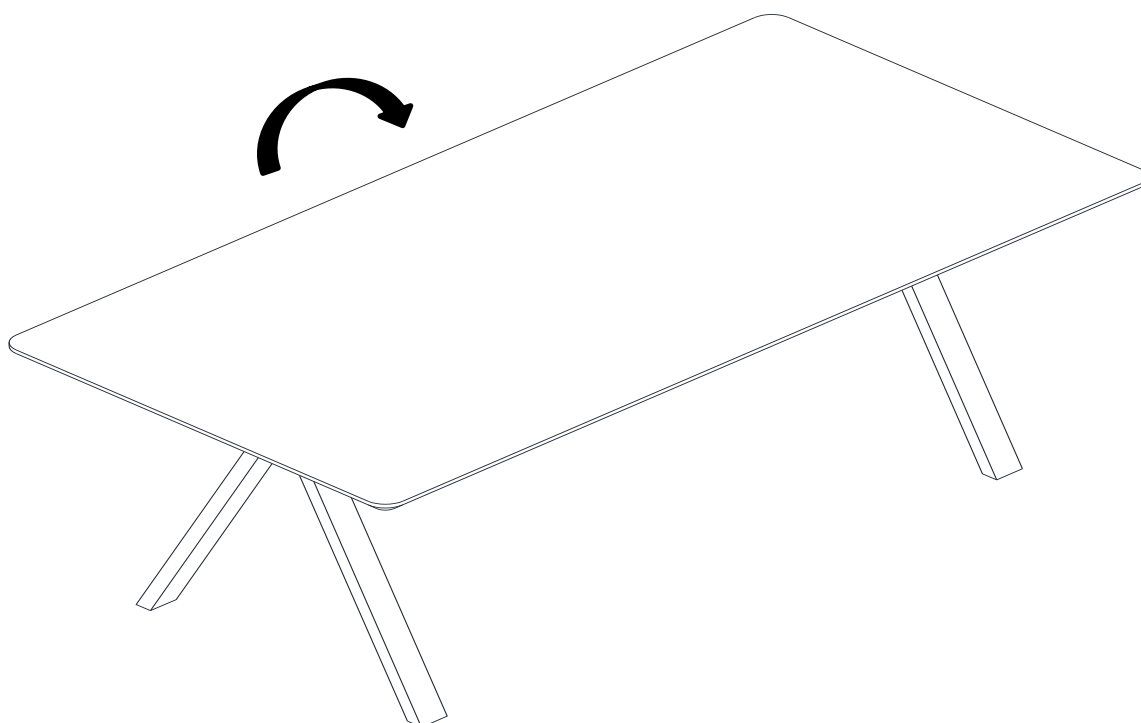



Maxvikt

